



Universal Hand Lift

MOUNTING INSTRUCTIONS

P/N: 4501-0785

**CUSTOMER MUST RECEIVE A COPY
OF THIS INSTRUCTION SHEET AT
THE TIME OF SALE**

Ref.	Qty.	Part#	Description
1	1	2607-100	Lift Handle
2	1	2607-200	Front Crank Arm
3	1	2607-300	Rear Crank Arm
4	1	2607-07	Rear Crank Clamp Plate
5	1	2607-08	Rear Crank Upper Bracket
6	2	2607-09	Front Crank Clamp Plate
7	1	2607-03	Pull Arm
8	1	HDW654	Chain / Snap Hook <small>HDW2336</small>
9	1	HDW2341	Nylon Strap w/Cambuckle
10	1	HDW4102	Grip
11	2	HDW2100	3/8" x 1" Hex Bolt
12	2	HDW7060	3/8" Flange Nut
13	6	HDW2066	5/16" x 2-1/4" Hex Bolt
14	2	HDW9035	5/16" x 2-1/2" Hex Bolt
15	6	HDW9002	5/16" Flat Washer
16	10	HDW7058	5/16" Nylock Nut
17	5	HDW9029	3/8" USS Flat Washer
18	2	HDW2161	3/8" x 3/4" Shoulder Bolt
19	1	HDW2331	Axle Cap

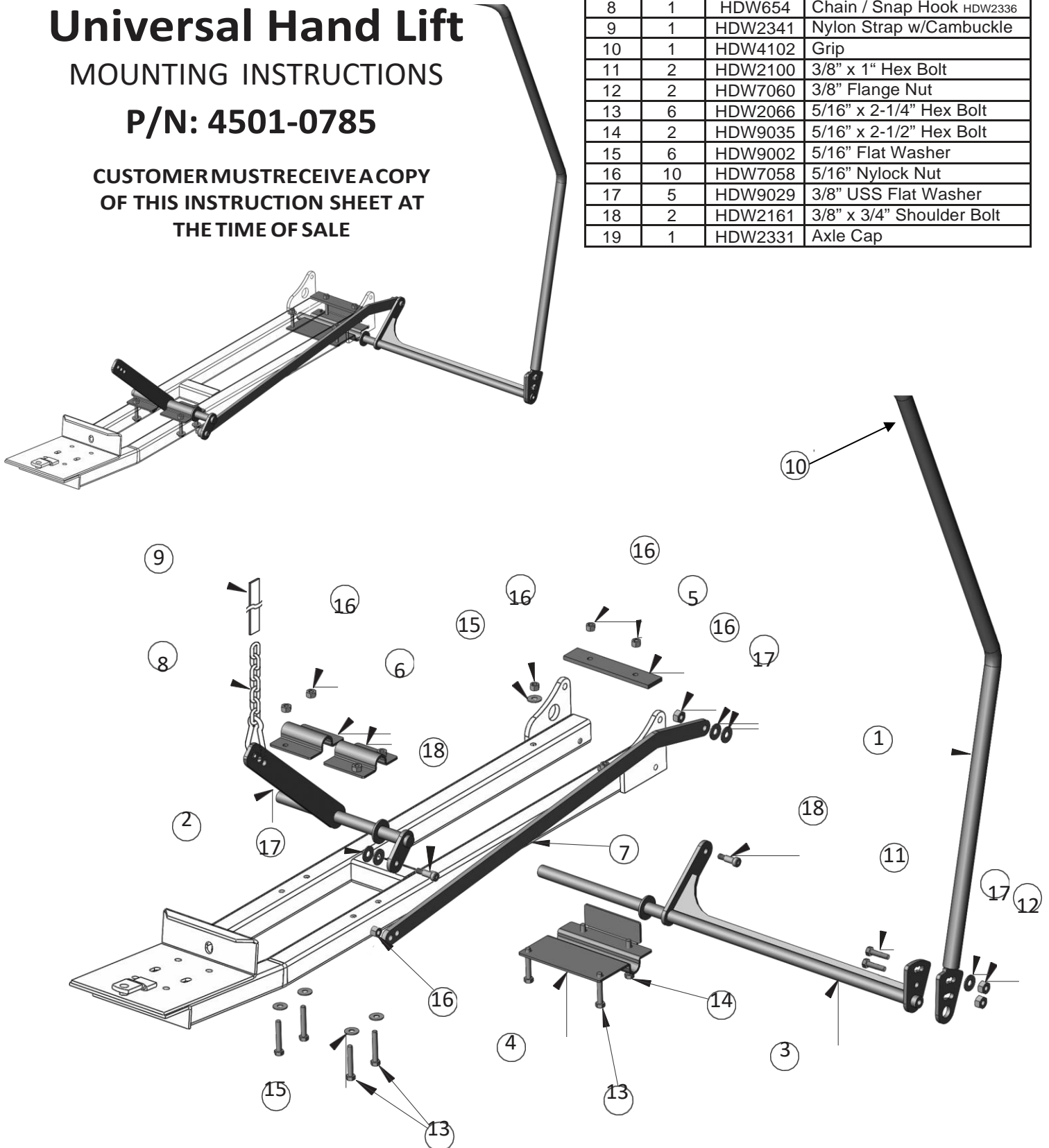

Universal Hand lift Mounting Instructions

Assembly:

1. Install the front crank arm (#2) on top of the push tube using the two front crank clamp plates (#6). The longer side of the clamp plates will face in towards each other. Place a very light coating of grease on the inner groove of each clamp plate. Sandwich the front crank between the push tube and clamp plates and bolt from the bottom through the existing holes in the push tubes using four 5/16" x 2-1/4" hex bolts (#13), four 5/16" flat washers (#15) and four 5/16" nylocknuts (#16).

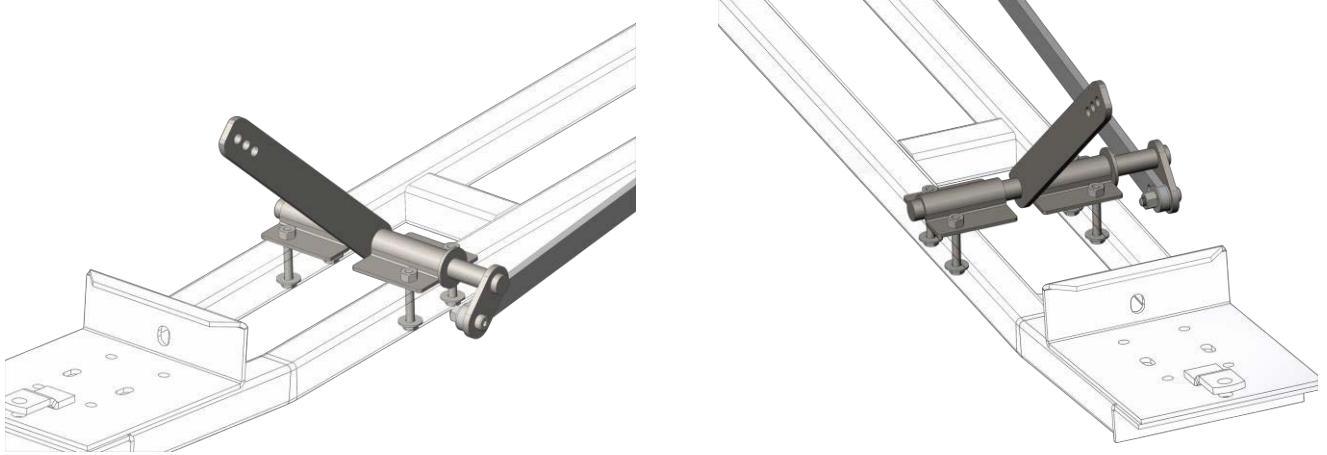

2. Place a very light coating of grease on the inner groove of the rear clamp plate (#4). Position the rear clamp plate in place underneath the back of the push tube per the illustration. Loosely bolt the front of the clamp plate up through the push tubes using two 5/16" x 2-1/4" hex bolts (#13), two 5/16" flat washers (#15), and two 5/16" nylock nuts (#16).

Place the rear crank upper bracket (#5) in place on top of the push tubes per the illustration. Loosely bolt the upper and lower brackets together from the bottom using two 5/16" x 2-1/2" hex bolts (#14) and 5/16" nylock nuts (#16).

Now slide the rear crank arm into the brackets from the left side. You can now tighten all the bolts and nuts being careful not to overtighten the rear bolts that sandwich the two brackets. Make sure the rear crank arm rotates freely and pound the axle cap (#19) into place on the right side of the crank arm shaft.

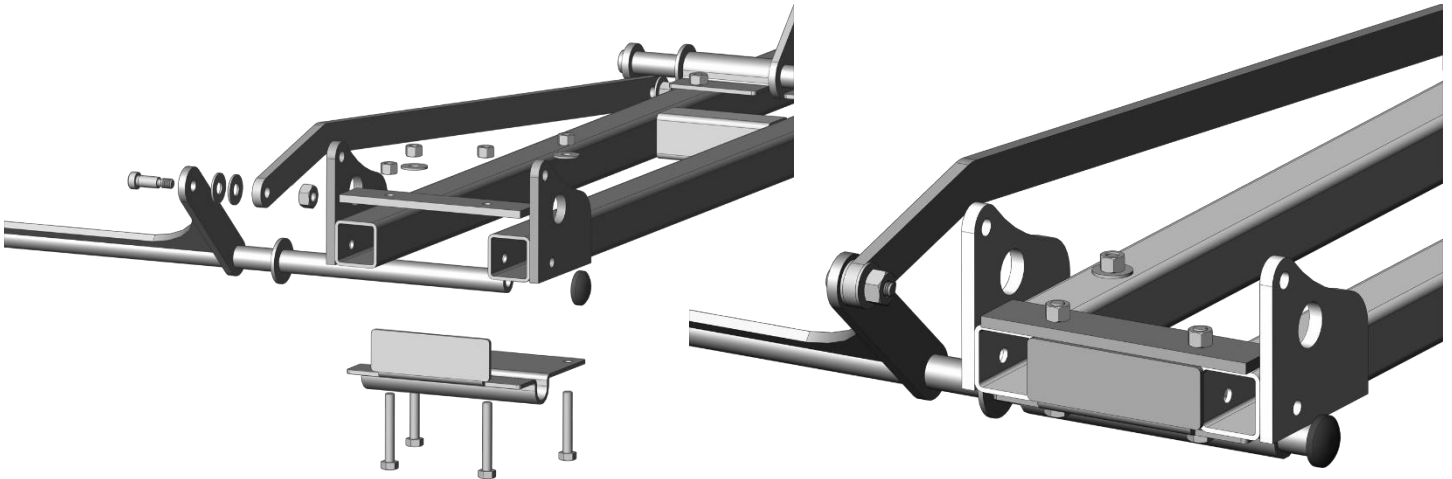

3. Connect the pull arm (#7) to the front and rear crank arms. The short bent end goes to the rear of the push tube per the illustration. There are two holes in the front of the pull arm to be used for adjustment to your particular ATV, start in the front hole, however you may need to switch holes at a later point. Bolt the front of the pull arm to the INSIDE of the front crank arm using a 3/8" shoulder bolt (#18), two 3/8" flat washers (#17), and 5/16" nylock nut (#16). **NOTE:** Both 3/8" washers go between the pull arm and front crank.

Bolt the rear of the pull plate to the bracket on the rear crank arm in the same fashion, the pull plate will again bolt to the INSIDE of the crank arm bracket. Both 3/8" washers will install between the two arms.

4. Install the grip onto the handle. Bolt the handle to the rear crank arm using two 3/8" x 1" hex bolts (#11) and two 3/8" flange nuts (#12) from the inside facing out. Install one 3/8" washer (#17) under the head of the top bolt. Utilize the center position for now, you may need to adjust it later.

Universal Hand lift Mounting Instructions

Installation:

1. Once your plow/hand lift are fully assembled you can attach it to your ATV. The hand lift is designed so that you can simply drive over the plow and handle and into position.
2. Pin the push tube into place in the bottom mount.
3. With the blade on the ground and the hand lift handle in the forward position attach the chain/strap around the rack or front bumper of your ATV. Snug up the strap so it is tight.
4. Pull back the handle to raise the plow. You will notice that as you pull back the handle it rotates the rear crank backwards which in turn pulls the lift rod on the front crank down (via the pull arm). This action lifts the plow off the ground as it cantilevers off of the chain/strap attached to the ATV. The handle needs to be pulled back far enough for the pull arm to "cam over" onto the rear crank which locks it in the up position.

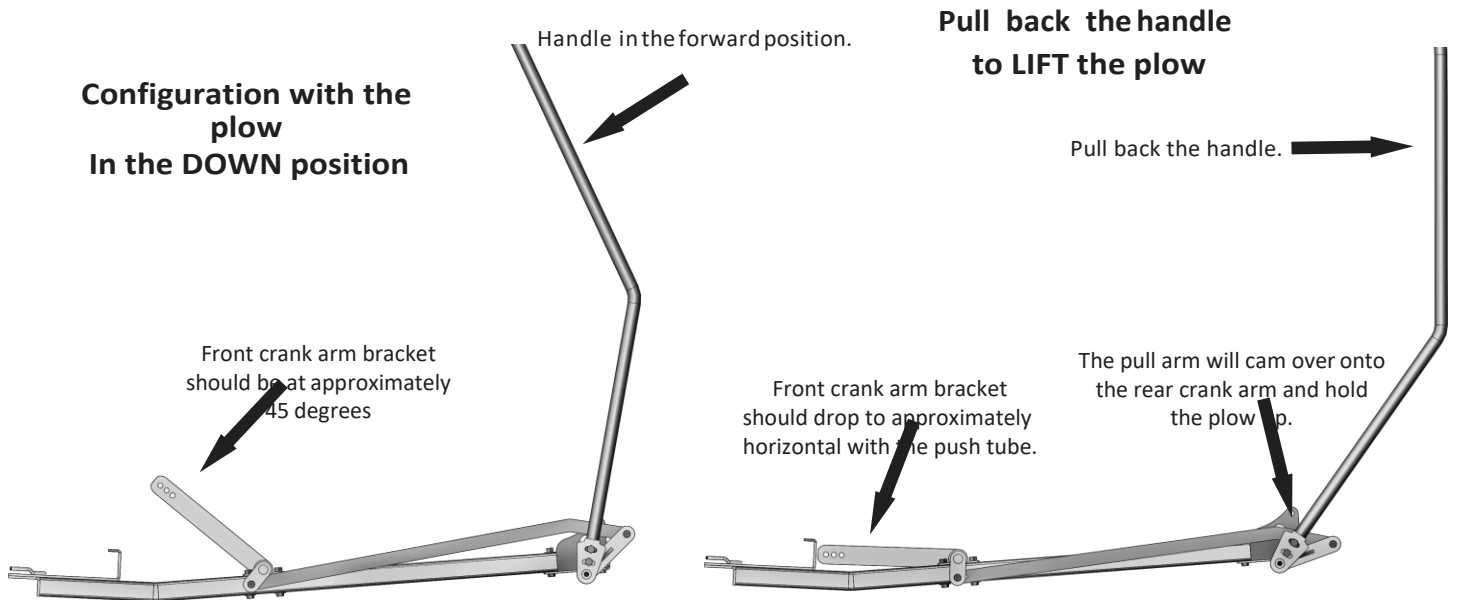

Adjustment:

The amount of lift you can achieve will be determined by your particular ATV and adjustment setup. Ideally the plow will lift all the way until the push tubes just contact the bottom of the ATV. Most machines will be in the 6" to 10" range.

1. Chain/strap adjustment holes in the bracket on the front crank. We recommend starting in the top hole but due to different machine configurations you may need to utilize the center or lower hole position. The top hole will give more lift but be harder to pull. Conversely, the lower hole will give less lift but be easier to pull.
2. Two adjustment holes in the front of the pull arm (Where it attaches to the front crank arm. These two hole options will give you more or less lift height. The front hole offers less lift height but will be easier to pull. If you need more lift height, use the back hole.
3. Handle adjustment. You should be able to travel all the way forward and back without hitting the fenders. If so, you can change the position of the handle forward or back with the adjustment at the bottom.

Universal Hand lift Mounting Instructions

Troubleshooting:

1. The plow will not lift at all.

- Chain strap either not attached at all or attached incorrectly. The plow lifts when the lever on the front crank is forced down. therefore the chain/strap must be connected from a hole in the lever up to the rack, bumper or other fixed component of the ATV. The strap DOES NOT come back down and attach to the plow.
- With the plow on the ground and the handle forward, be sure to snug up the strap so it is tight.
- Front crank may be installed backwards or incorrectly. See illustrations to make sure it is installed the correct direction.
- Ensure the lever on the front crank operates properly. Disconnect the chain/strap from the front crank lever. With the plow on the ground and the handle in the forward position the lever should be pointing upwards at approximately a 45 degree angle. When the handle is pulled back the lever should rotate down until it is horizontal facing the back of the plow blade. If not, review the assembly instructions to see what maybe assembled incorrectly.
- Part of the ATV may be interfering with the moving components of the hand lift. Have someone watch the hand lift components as you try to raise the plow to determine if there is some interference.

2. The plow will lift some but will not cam over and stay in the up position.

- Chain/strap may be loose. Retighten the strap with the plow on the ground and try again.
- Pull arm may be installed incorrectly to the outside of the bracket on the rear crank. It must be installed to the inside of the rear crank.
- Handle may be hitting the rear fender or not adjusted forward far enough. Remove the handle mounting bolts, adjust the handle farther forward and reinstall the bolts.
- May need more lift adjustment. Move the chain to the top hole in the bracket on the front crank and try again. If that did not fix the problem, change pull rod hole position. You will want to use the rear hole in the pull rod and re-attach it to the front crank.
- Part of the ATV may be interfering with the moving components of the hand lift. Have someone watch the hand lift components as you try to raise the plow to determine if there is some interference.
- The push tube may be bottoming out on the frame of the ATV before the handle is all the way back. If so, reduce some lift height by either putting the chain into a lower hole of the front crank arm or changing to the front hole of the pull rod where it attaches to the front crank.

3. The hand lift was working fine but now it will not lift properly or as high.

- The cam lock on the strap may have slipped or came loose. Snug it back up tight with the plow on the ground.
- A component may be bent or broken. Inspect each part for any damage and replace as necessary.