

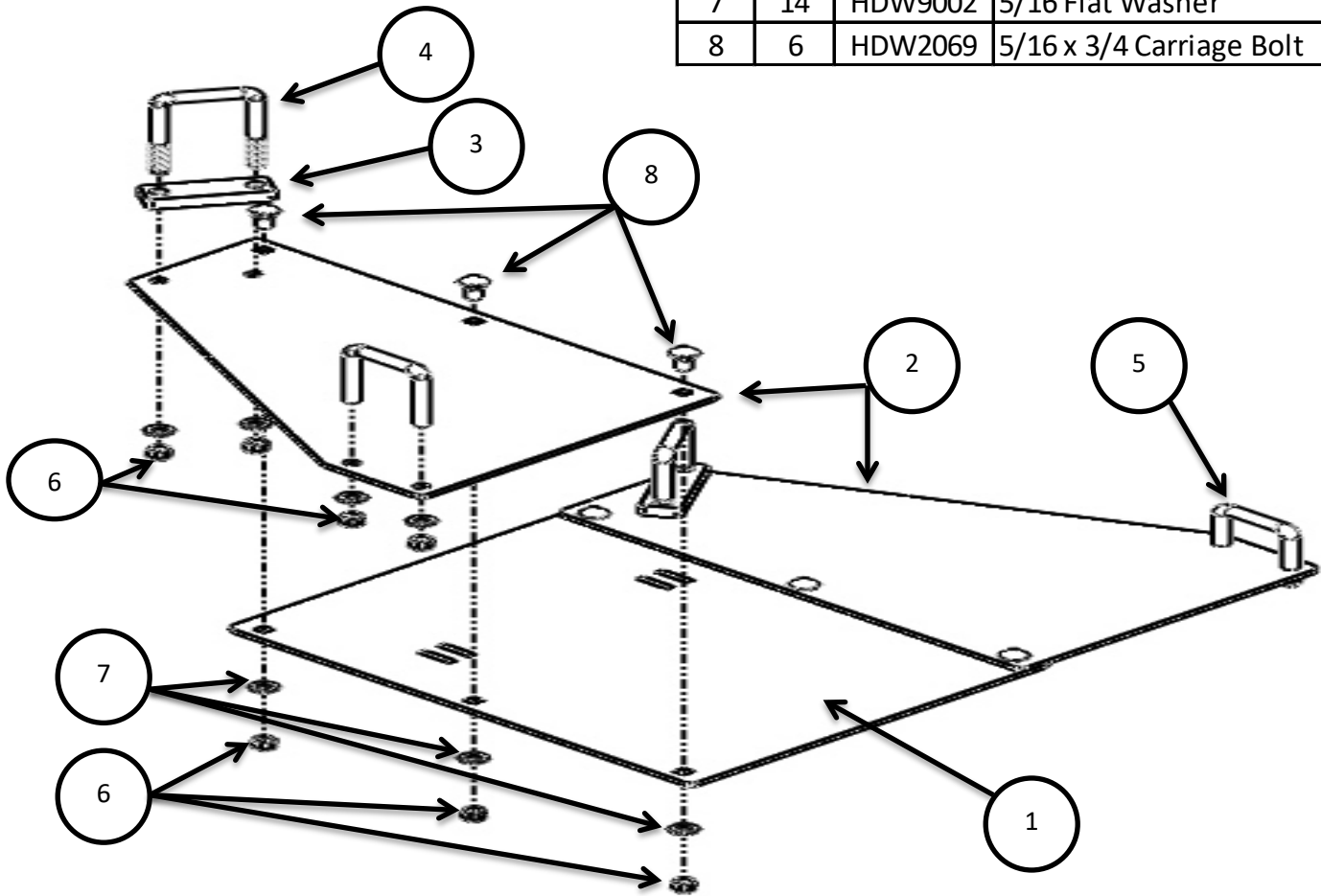

**CF MOTO Z-FORCE 800EX  
Plow Mount Installation Instructions**

**PART# 4501-0650**

ITEM	QTY.	PART#	DESCRIPTION
1	1	2808-100	Bottom Mount Plate (center)
2	2	2808-2	Bottom Mount Side Plates
3	2	HDW9424	U-Bolt Block Spacer
4	2	HDW9062	5/16 x 2 x 3-1/2 Sq. U-Bolt
5	2	HDW2401	5/16 x 2 x 2-1/2 Sq. U-Bolt
6	14	HDW7058	5/16 Nylocj Nut
7	14	HDW9002	5/16 Flat Washer
8	6	HDW2069	5/16 x 3/4 Carriage Bolt



**Front U-Bolt mounting location**

**Rear U-Bolt mounting location**

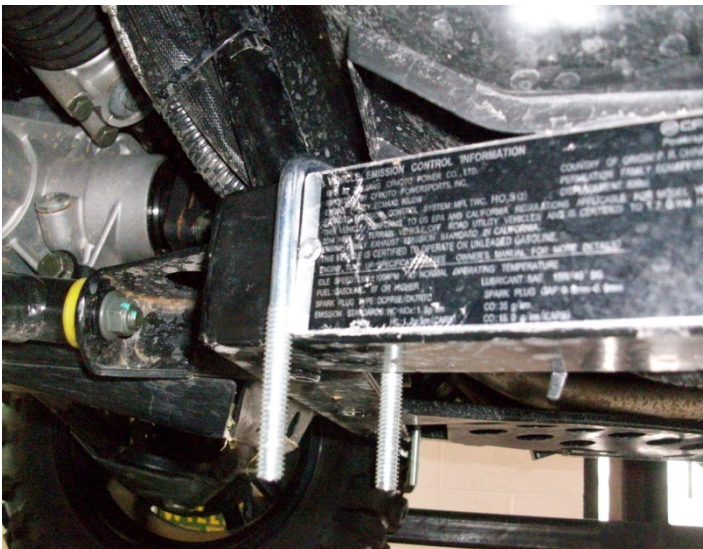

Questions or comments call 320-964-1616 Mon. thru Thur. 7:00 to 4:30 CST

INST2808PF



**PLOW MOUNTING INSTRUCTIONS  
CF MOTO Z-FORCE 800EX  
PART# 4501-0650**



This image is from the front of machine on the drives side.

This shows the U-bolt mounting locations.

First you will have bolt the plow mount side plates to the main plate as shown on the illustration on the first page. Bolt together using the 6 – 5/16 x 3/4 Carriage bolts washers and nylock nuts. (NOTE: the tabs on center plate should go toward the front or forward location)



The 5/16 x 2 x 3-1/2 U-bolt will go in the forward location around the frame tube. You will also use the U-bolt spacer block in the forward position going between the frame tube and the mount plate.

The 5/16 x 2 x 2-1/2 U-bolt will go in the back with the U-bolt going through the hole in the floor board support. Use the remaining washers and nylock nuts to secure mount up in place.

After usage check and retighten the bolts and make sure the mount is staying secure.

