

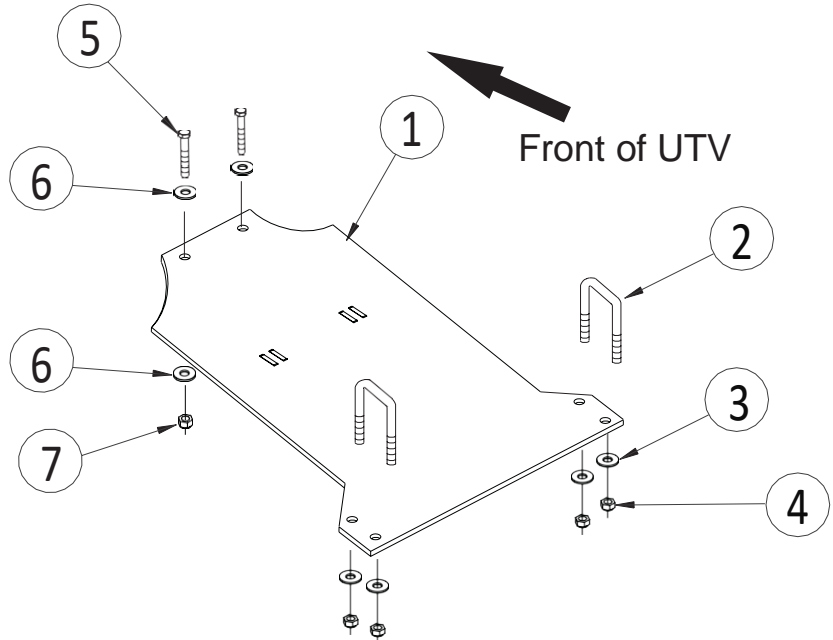

Item	Part #	Qty.	Description
1	2804-100	1	Bottom Mount
2	HDW2401	2	5/16" x 2" x 2-1/2" Sq. U-bolts
3	HDW9002	4	5/16" Flat Washers
4	HDW7058	4	5/16" Nylock Nut
5	HDW2100	2	3/8" x 1" Hex Bolts
6	HDW9029	4	3/8" Flat Washers
7	HDW7061	2	3/8" Nylock Nuts
8	HDW2054	2	5/16 x 1-14 x 2-1/4 Sq U-Bolt

BOTTOM MOUNT
2014 Kawasaki
MULE PRO-FXT
4501-0647

**CUSTOMER MUST RECEIVE A COPY
 OF THIS INSTRUCTION SHEET AT
 THE TIME OF SALE**



BOTTOM MOUNT INSTALLATION INSTRUCTIONS

1. Remove the center skidplate.
2. Locate the two open holes in the frame between the front differential and the steering rack. They will be 4-3/4" apart from each other. Drop a 3/8" x 1" hex bolt (#5) with flat washer (#6) down through each hole. See illustration on back page.
3. Install the rear square u-bolts (#2) over the main horizontal frame rail that runs side to side under the machine. Locate the u-bolts about 8 inches in from each side. See illustrations on back page.
4. The narrow side of the mount is the front. Align the mount so it will fit over the two front hanging bolts and loosely install the 3/8" flat washers (#) and nylock nuts (#). Push the back of the mount up into place over the four hanging u-bolts and loosely install the 5/16" flat washers (#3) and nylock nuts (#4). Make sure the mount is aligned properly and tighten all the hardware.

NOTE: If you would like to continue using your skidplate, simply mark the locations of each u-bolt and drill out a hole for each one. You can then re-install the skidplate with the u-bolts sticking down through it, put the bottom mount in place and install the washers/nuts.

5. Using a cut off wheel or reciprocating saw you can cut of any excess threads hanging down from the u-bolts.
6. Slide the blade/push tube assembly under the ATV. Lift the rear of the assembly up and align the holes in the bottom mount tabs and push tube and install the wire loop pins.

BOTTOM MOUNT INSTALLATION INSTRUCTIONS KAWASAKI MULE PRO FXT

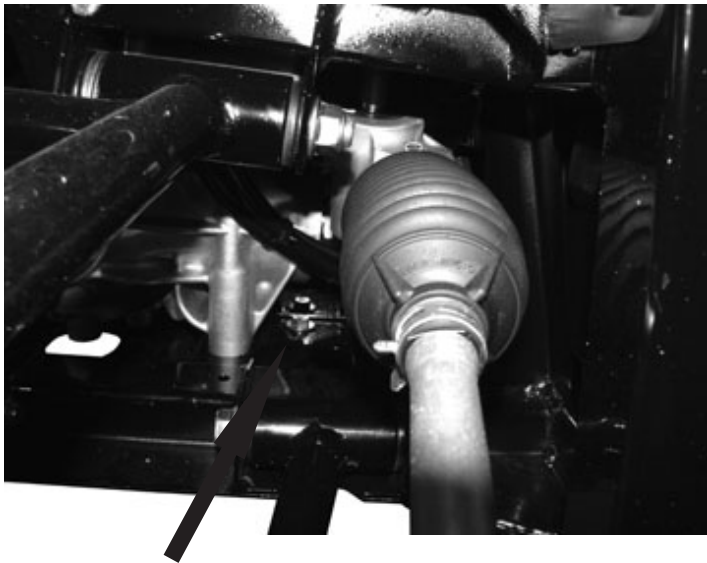

Drop the 3/8" bolts and washers down through the open holes in the frame between the steering rack and front differential.



Proper position of the 3/8" bolts hanging down through the frame.



Front of UTV

Rear u-bolts are positioned over the center frame tube.

NOTE: On the 2019 and up machines use the smaller u-bolt on the inside set of holes for a tighter fit on the back portion.

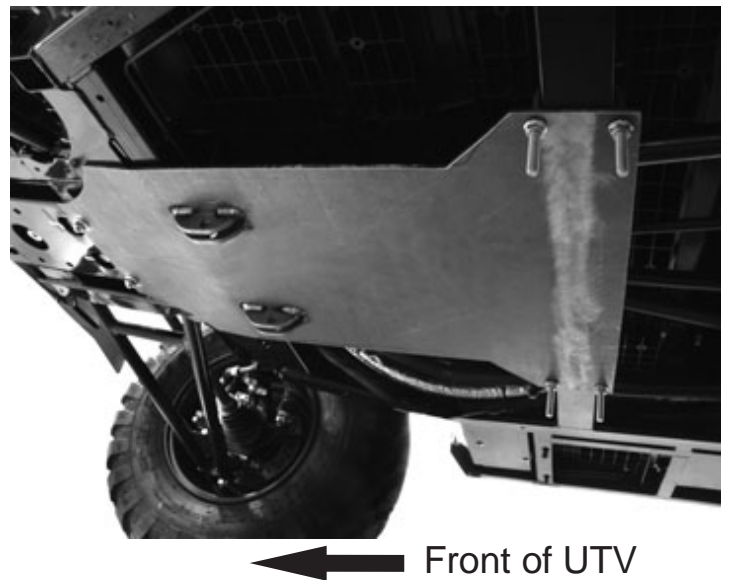

Front of UTV

Completed installation.