



## RM4 Plow Mount Installation Instructions

13-15 650 Outlander XT / Max

2016 570 Outlander XT

13-14 Outlander 500 Standard and Max

**PART# 4501-0811**

ITEM	PART#	QTY.	DESCRIPTION
1	2583-100	1	RM4 Mount Plate
2	KD100	1	Removable Mount
3	HDW9185	1	1/2 Cotterless Hitch Pin
4	HDW2102	2	3/8 x 1-1/4 Hex Bolt
5	HDW9002	4	5/16 Flat Washer
6	HDW7058	4	5/16 Nylock Nut
7	HDW1056	4	8mm x 40mm Hex Bolt
8	HDW7061	2	3/8 Nylock Nut
9	HDW2050	2	5/16 x 3/4 Hex Bolt
10	HDW2061	2	5/16 x 1-1/4 Hex Bolt

The RM4 Mount kit is designed to allow for quick removal when not needed for plowing. This mount design uses the machines front bumper and frame member to push against and distribute the load when plowing. See below for installation instructions of the mount kit. **NOTE:** This RM4 mount will fit with the Can-Am winch mount kit. If you are experiencing difficulties installing with another brand of winch mount we recommend purchasing a Can-Am winch mount. This mount will NOT work with 2-bolt pattern winches, you must use a 4-bolt pattern winch.

### INSTALLATION:

1. Remove the lower front plastic skidpan, you will need to loosen or remove the front brushguard to do so. The RM4 permanent mount will mount up against the steel bumper framework. See Illustration on back page.
2. If your winch is already installed you will want to leave it in place but remove the mounting bolts and the roller fairlead.
3. Hold the mount plate in place on the machine lining up the roller fairlead mounting holes. The holes in the mount plate will now line up with the holes in the metal frame of the ATV. Use four of the included 8mm x 40mm hex bolts to loosely install through the mount plate, through the metal bumper bracket, and back into the winch.
4. Locate the two 5/16" x 1-1/4" hex bolts, 5/16" nylock nuts and two 5/16" flat washers. Use this hardware to loosely bolt the bottom of the RM4 mount plate to the frame.
5. Loosely bolt the two remaining upper holes (not the roller fairlead holes) in the mount plate to the frame using two 5/16" x 3/4" hex bolts, 5/16" nylock nuts and 5/16" flat washers.
6. Ensure the holes for the roller fairlead are all still aligned and tighten all the nuts/bolts.
7. You will need to trim off the lower portion of the plastic skidpan for clearance with the RM4. Hold the skidplate in place and mark the area that will need to be trimmed out for the mount and receiver to fit. Use a sharp knife, hacksaw, or other cutting tool to cut the skidpan. Reinstall the skidpan and roller fairlead using the 3/8" x 1-1/4" hex bolts and 3/8" nylock nuts.

**FOR QUESTIONS OR COMMENTS PLEASE CALL: 320-964-1616 (7:00 to 4:30 CST Monday through Thursday).**

INST2583PF-1



# RM4 Plow Mount Installation Instructions

Can-Am Outlander  
Part #: 4501-0811

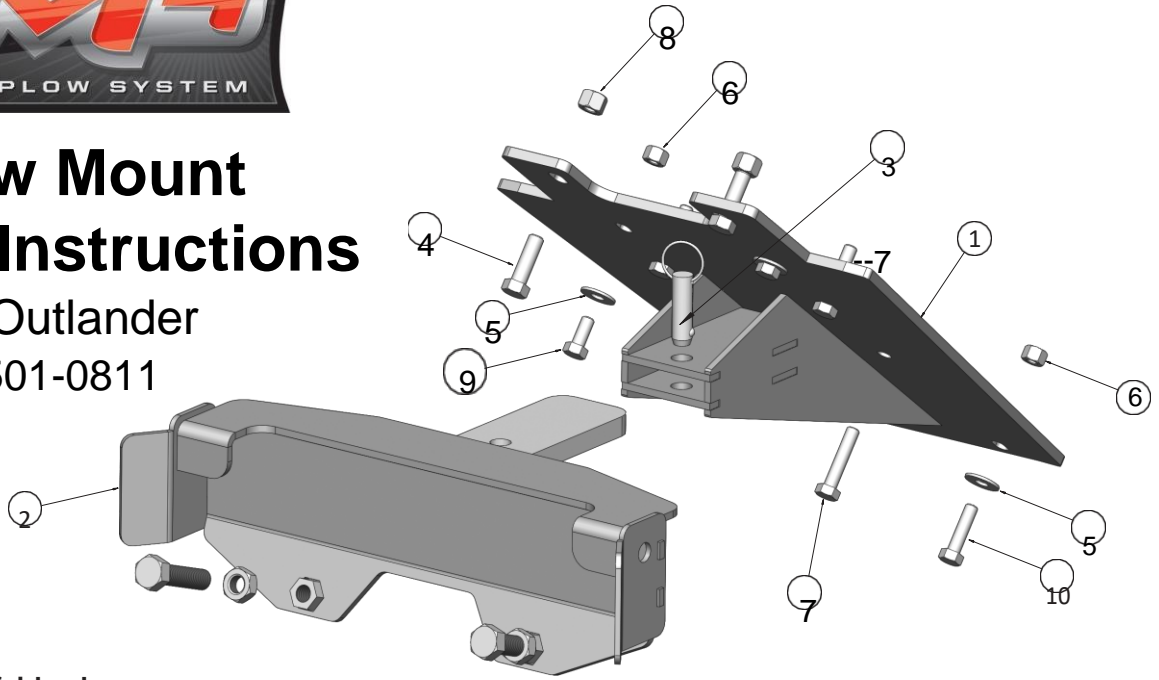

Machine shown with roller fairlead and bumper cover removed.



Mount in place on the machine. Winch will need to be bolted back into place through the mount and frame.

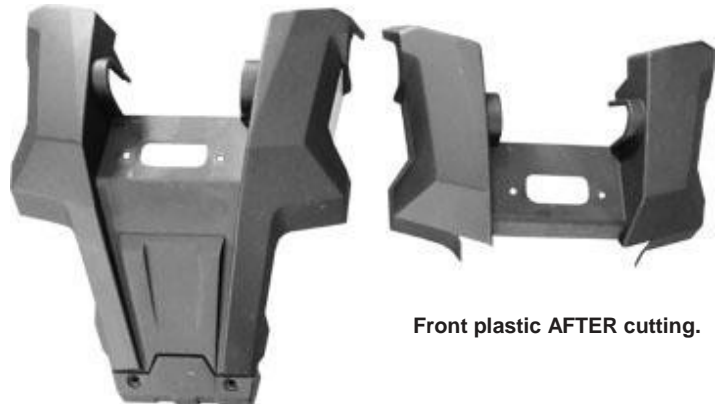

Front plastic AFTER cutting.

Front plastic BEFORE cutting.