



RM4 PLOW MOUNT INSTRUCTIONS

05-19 SUZUKI KING QUAD 450/500/700/750

PART# 4501-0797

ITEM	PART#	QTY.	DESCRIPTION
1	2594-100	1	RM4 Plow Mount Weldment
2	KD100	1	Removable Mount
3	HDW9185	1	1/2 cotterless hitch pin
4	HDW2150	2	5/16 x 1-1/8 x 1-3/4 Rd. U-Bolt
5	HDW2051	4	5/16 x 1 Hex Bolt
6	HDW9002	12	5/16 Flat Washer
7	HDW7058	10	5/16 Nylock Nut
8	2594-104	2	Fairlead Spacer
9	HDW2055	2	5/16 x 2-3/4 Hex Bolt
10	HDW4104	4	End Caps

The RM4 mount is designed for quick removal when not needed for plowing. This mount design uses the machine's front bumper and frame member to push against and distribute the load when plowing. See below for installation instructions of the mount kit. **NOTE:** If you are experiencing difficulties installing with another brand of winch, we recommend purchasing a Moose winch mount kit.

INSTALLATION:

1. Remove the front plastic upper and lower bumper covers. **If you already have a winch installed:** You will need to unbolt the winch mount (but keep in place) to ease the installation of the RM4 mount.
2. The RM4 permanent mount (#1) will slide on either side of the frame mounting tabs. These are the same tabs that the winch mount will bolt to. The back formed tab on the RM4 mount will u-bolt around the main frame tubes. See illustration.
3. With your winch mount unbolted, hold the RM4 mount in place on the OUTSIDE of the frame tabs and loosely bolt in place with the 5/16" x 1" hex bolts (#5), 5/16" flat washers (#6) and the 5/16" nylock nuts (#7). You are bolting together the RM4 mount, frame mount and winch mount.
4. Slide the 1-1/8" x 1-3/4" u-bolts (#4) around the back of the frame tubes just above the a-arm mounts and through the holes in the formed flange of the RM4 mount. Secure with the 5/16" flat washers (#6) and nylock nuts (#7).
5. Tighten all nuts/bolts.
6. The Suzuki (and possibly some other brands) winch mount places the roller fairlead in the machine too far for proper pull angle with the RM4. In this case, use the included roller fairlead spacers to space the fairlead out towards the front of the machine. Lightly tap the spacer endcaps (#10) into each end of spacers and bolt the spacers in place between the winch mount and roller fairlead. Use two 5/16" x 2-3/4" hex bolts (#9) and 5/16" nylock nuts (#7). You will not need to use the spacers with the Moose winch mount kit.
7. Reinstall the upper and lower plastic bumper covers.

FOR QUESTIONS OR COMMENTS PLEASE CALL: 320-964-1616 (7:00 to 4:30 CST Monday through Thursday).

INST2594PF-1



RM4 Plow Mount Installation Instructions

2005-11 Suzuki King Quad
450/500/700/750

Part #: 4501-0797

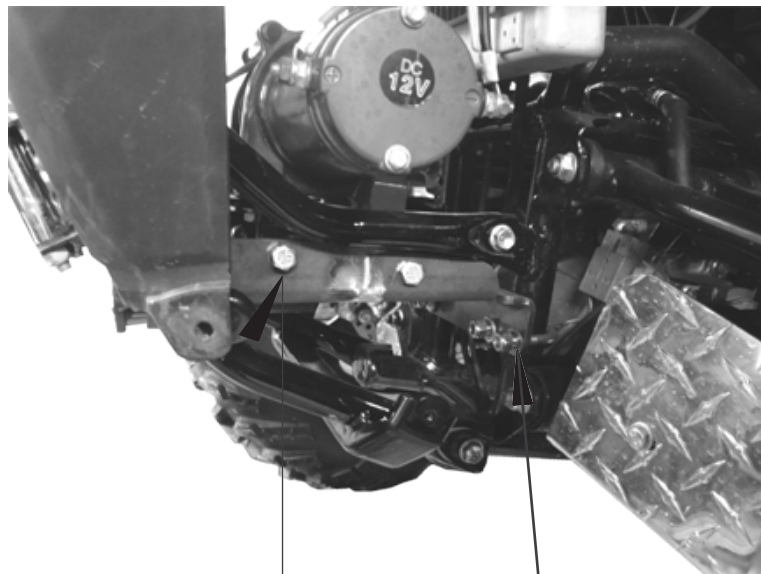
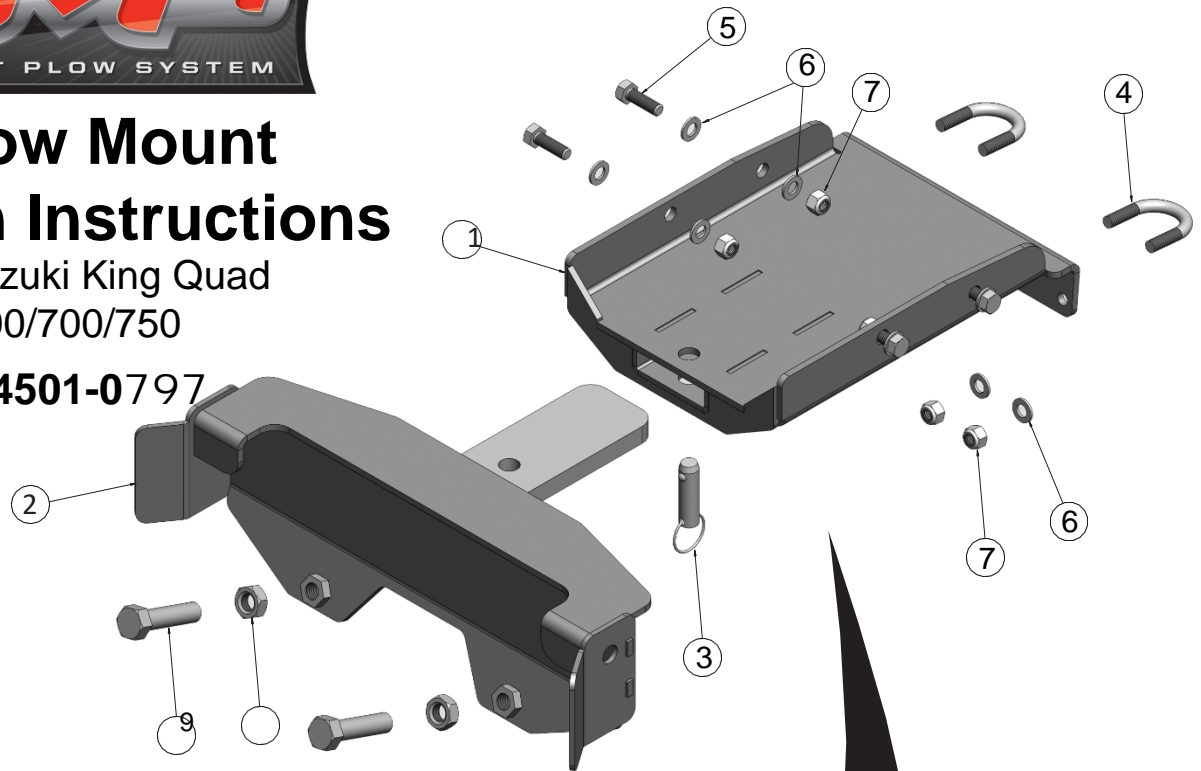

The sides bolt to the outside of the main frame mounts. The winch mount uses the same holes but bolts to the inside of the frame mounts.

The bottom of the RM4 mount is u-bolted around the main frame tubes.

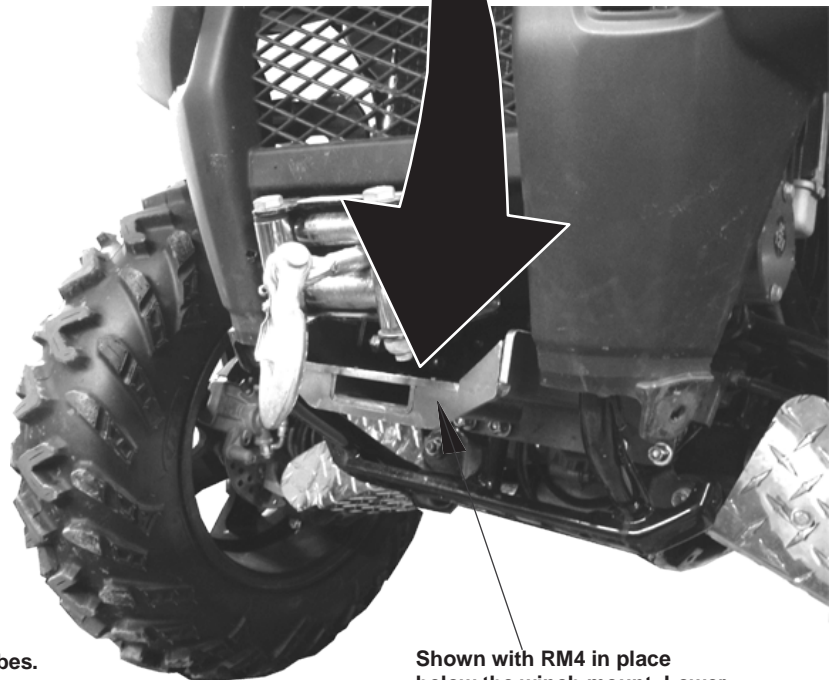

Shown with RM4 in place below the winch mount. Lower plastic is removed for clarity.

WARNING!

THIS MOUNT KIT IS DESIGNED TO WITHSTAND NORMAL PLOWING FORCES AT A MAXIMUM SPEED OF 5 MPH. EXCESSIVE PLOWING SPEED OR IMPACTING IMMOVABLE OBJECTS MAY DAMAGE THE PLOW, MACHINE, OR OPERATOR AND WILL NOT BE WARRANTED. THIS PLOW SYSTEM IS COVERED BY A ONE YEAR WARRANTY FROM DEFECTS IN MANUFACTURING. PLEASE CONTACT THE MANUFACTURER AT THE NUMBER LISTED BELOW FOR ANY POSSIBLE WARRANTY CLAIMS. BENT OR BROKEN COMPONENTS FROM ABUSE OR EXCESSIVE SPEED WILL NOT BE WARRANTED.

FOR QUESTIONS OR COMMENTS PLEASE CALL: 320-964-1616 (7:00 to 4:30 CST Monday through Thursday).