



RM4 Plow Mount Installation Instructions

2004-11 Can-Am Outlander 500/650/800

Ref.	Qty.	Part#	Description
1	1	2582-100	Mount Plate
2	1	KD100	Removable Mount
3	2	in push tube	1/2" Nylock Nut
4	2	in push tube	1/2" x 2" Hex Bolt
5	1	HDW9185	Locking Pin
6	2	HDW2102	3/8" x 1-1/4" Hex Bolt
7	2	HDW7061	3/8" Nylock Nut

Part #: 4501-0787

The RM4 Mount kit is designed to allow for quick removal when not needed for plowing. This mount design uses the machines front bumper and frame member to push against and distribute the load when plowing. See below for installation instructions of the mount kit.

NOTE: This RM4 mount will fit with both the Moose winch mount kit and the Can-Am winch mount kit. If you are experiencing difficulties installing with another brand of winch mount we recommend purchasing a Moose winch mount kit.

NOTE: The pulley kit (#4501-0699 sold separately) will be required to assist your winch in lifting the plow system.

INSTALLATION:

1. Remove the front bumper (XT models) and front lower plastic skidplate. Remove the 2 lower front aluminum bumper bolts. If you already have a winch installed: Remove the two bolts that hold the lower portion of your winch mount in place. Loosen but do not remove the top winch mount bolts. Remove the roller fairlead.
2. The RM4 permanent mount will install behind the roller fairlead mount up front and in between the lower bumper mounts and the winch mount plate down below. You may need to loosen the front bumper tubes to get the mount in place. See Illustration.
3. Bolt the rear of the mount in place using the four existing bolts and nuts. The bumper will be on the bottom, RM4 mount in the middle, and winch/frame mounts on top.
4. You will need to trim the plastic skidplate for clearance with the RM4. Hold the skidplate in place and mark the area that will need to be trimmed out for the mount and receiver to fit. Use a sharp knife, hacksaw, or other cutting tool to cut out the skidplate. Put skidplate back in place. See Illustration.
5. Bolt the front of the RM4 mount to the back of the bumper mounts where the roller fairlead attaches. Bolt from the front using the two 3/8" x 1-1/4" hex bolts and 3/8" nylock nuts through the roller fairlead, plastic skidplate, bumper, and RM4 mount. You may need to reverse the two vertical bolts on the vertical rollers so the nuts are on the top instead of the bottom so the removable mount can slide into place.
6. Locate the 1/2" bolts installed in the push tube. These are used as droop stops to keep the plow from dropping down too far. Thread them in about half way for now. Slide the removable mount into place on the machine mount and pin into place from the top with the locking pin (#5). You can now attach your push tube and plow assembly.
7. Adjust both droop stop on flat ground, adjust the bolts so there is 1/4" to 1/2" clearance between the bolt heads and the bottom of the push tube or from push tube to mount. Tighten the lock nuts. **NOTE: Failure to properly adjust the droop stop bolts can put excessive load on the mount, the machine, and winch. This may cause damage and will not be warranted.**

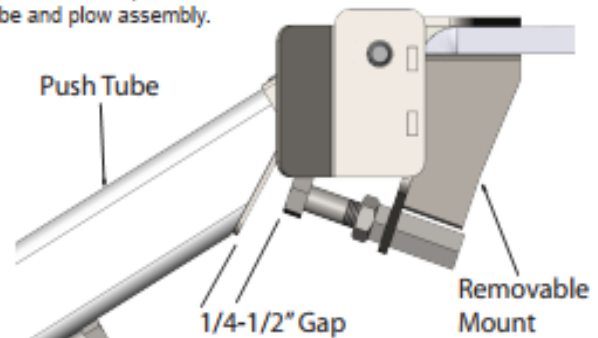

WARNING!

THIS MOUNT KIT IS DESIGNED TO WITHSTAND NORMAL PLOWING FORCES AT A MAXIMUM SPEED OF 5 MPH. EXCESSIVE PLOWING SPEED OR IMPACTING IMMOVABLE OBJECTS MAY DAMAGE THE PLOW, MACHINE, OR OPERATOR AND WILL NOT BE WARRANTED. THIS PLOW SYSTEM IS COVERED BY A ONE YEAR WARRANTY FROM DEFECTS IN MANUFACTURING. PLEASE CONTACT THE MANUFACTURER AT THE NUMBER LISTED BELOW FOR ANY POSSIBLE WARRANTY CLAIMS. BENT OR BROKEN COMPONENTS FROM ABUSE OR EXCESSIVE SPEED WILL NOT BE WARRANTED.





RM4 Plow Mount Installation Instructions

2004-11 Can-Am Outlander 500/650/800

Part #: 4501-0787

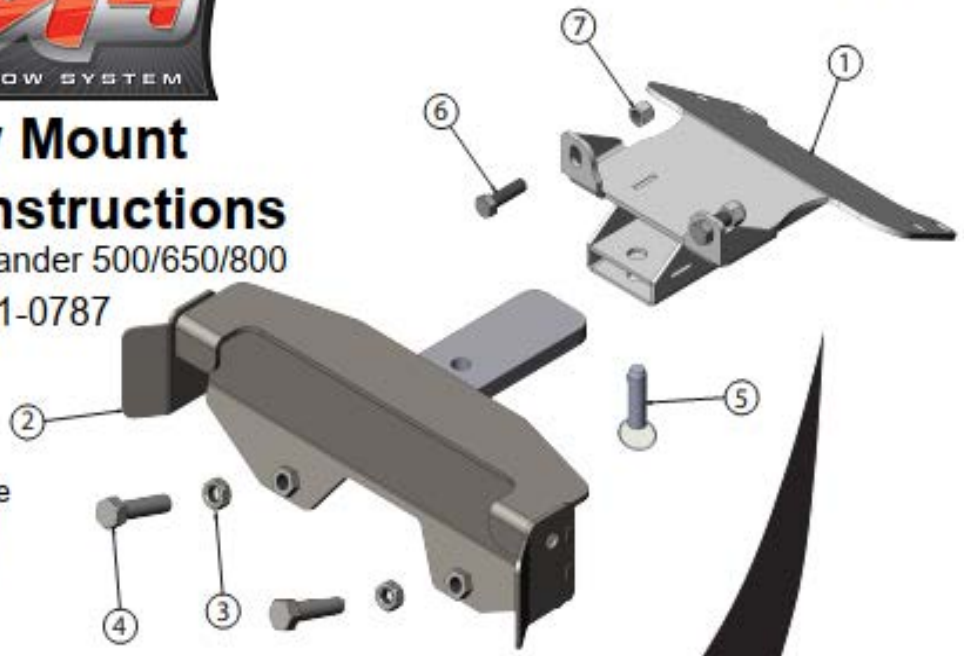

Items 4 and 3 are
Pre-assembled
in the push tube
on new models

Front of RM4 mount butts
against the back of the roller fairlead mounts
on the bumper.

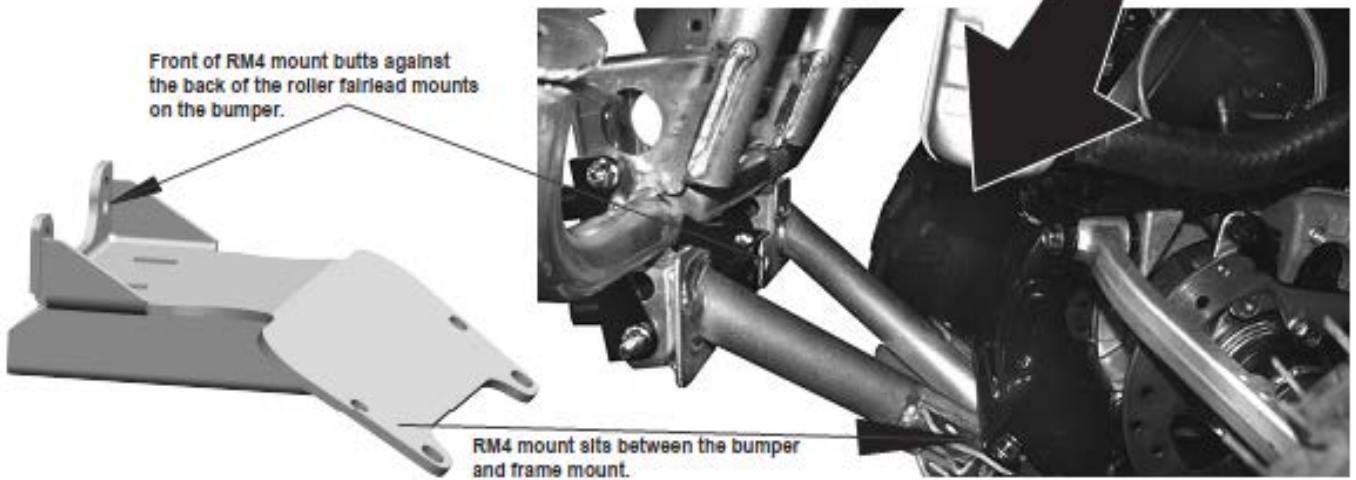

RM4 mount sits between the bumper
and frame mount.



Front plastic AFTER cutting.



Properly Installed mount. Shown with plastic removed.