



**RM4 PLOW MOUNT INSTRUCTIONS**  
POLARIS SPORTSMAN 400/500/570/800

**PART# 4501-0072**

**Most RM4 plow mounts are designed to work with Moose winch mounts.**

ITEM	QTY.	PART#	DESCRIPTION
1	1	2592-100	Plow Mount
2	1	2592-105	Right Support Bracket
3	1	2592-106	Left Support Bracket
4	1	KD100	Removable Mount
5	2	HDW7078	Pre-Assembled in Push Tube
6	2	HDW9110	Pre-Assembled in Push Tube
7	1	HDW9185	1/2" Cotterless Hitch Pin
8	2	HDW2102	3/8 x 1-1/4 Hex Bolt
9	2	HDW7061	3/8 Nylock Nut
10	2	HDW9001	3/8 Flat Washer
11	2	HDW9428	5/8 x 3/8 Spacer
12	2	HDW2051	5/16 x 1 Hex Bolt
13	4	HDW9002	5/16 Flat Washer
14	2	HDW9003	5/16 USS Flat Washer
15	2	HDW7056	5/16 Serrated Flange Nut

1. Remove the front lower plastic piece. If you already have a winch installed: You will need to unbolt the winch mount to ease the installation of the RM4 mount. Remove the bolts for the mount but leave the winch and mount in place on the machine.

**NOTE:** If using a Polaris winch mount, leave the winch orientated in the normal position but flip the mount upside down. Failure to do so will cause the RM4 to interfere with the mount. After installation, drill a 1/2" hole through the winch mount for the RM4 pin clearance. Use the pin holes in the RM4 mount as a guide.

2. The RM4 permanent mount (#1) will slide over the towhook and bolt in place to the front bumper brackets. The support brackets (#2, 3) will bolt to the outside of the vertical frame member supports and tie back into the main mount plate. Your winch mount will install to the inside of these frame support brackets and utilize the same holes. See Illustration on back page.

3. Remove the two factory bolts located just underneath the towhook loop. Slide the mount (#1) in place and loosely bolt the bottom where you removed the bolts earlier using the two 5/16" x 1" hex bolts (#12), 5/16" SAE flat washers (#13) and 5/16" whiz nuts (#15). Due to the recess in the machine, you must place the two larger 5/16" USS spacer washers (#14) between the frame and the mount. The whiz nuts are very difficult to access with a normal socket and may require using a short 1/2" swivel socket.

4. You will now loosely bolt together the two upper mounting holes in the mount to the frame and support arms. Use the 3/8" x 1-1/4" hex bolts (#8), 3/8" washers (#10), 3/8" spacers (#11), and 3/8" nylock nuts (#9). Install the bolts from the front first through the mount, then the spacer, the frame, the support bracket, and finally the flat washer and nylock nut. See Illustration. Orientate the support brackets (#2, 3) per the illustration so they line up with the outside of each frame support.

5. Reinstall your winch mount to the inside of the frame support brackets. Using your original hardware, you will now bolt together the RM4 mount support brackets, frame supports, and winch mount. Once everything is in place, tighten all the bolts and nuts.

6. You will need to trim the front lower plastic for clearance with the RM4. Hold the plastic in place and mark the area that will be trimmed out for the mount and receiver to fit. See Illustration on back page. Use a sharp knife, hacksaw, or other cutting tool to cut out the skidplate. Reinstall skidplate.

7. Once the plow mount is installed, you may hook up the push tubes and blade. Adjust the droop stop bolts so there is about 1/2" to 3/8" gap between the bolt head and the removable mount. On some older models, the droop stop bolts may be in the removable mount. In the new style, they are pre-installed in the push tube.

**FOR QUESTIONS OR COMMENTS PLEASE CALL: 320-964-1616 (7:00 to 4:30 CST Monday through Thursday).**

INST2592PF-1



# RM4 Plow Mount Installation Instructions

Sportsman 400, 500, 570, 800

PART# 4501-0772

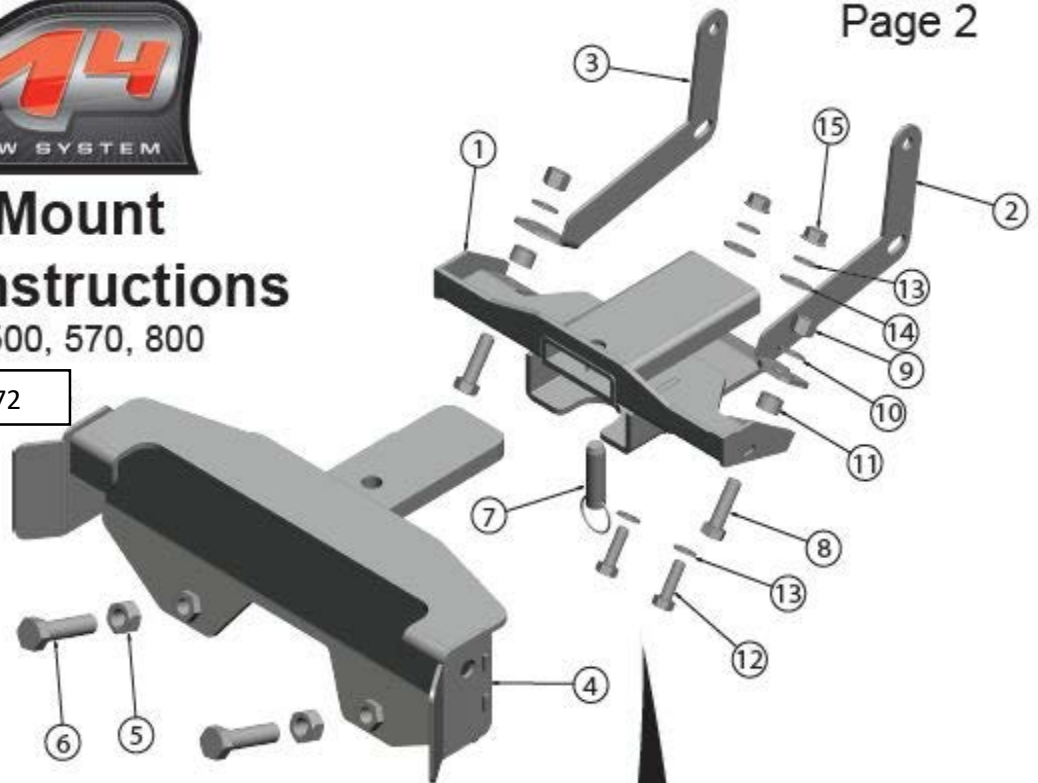

Bolt the mount in place using the 3/8" hardware. The spacers must go between the frame and the RM4 mount.



Remove factory bolts and bolt the mount in place using the 5/16" hardware. Make sure to put the 5/16" USS spacer washers in between the frame and the RM4 mount.

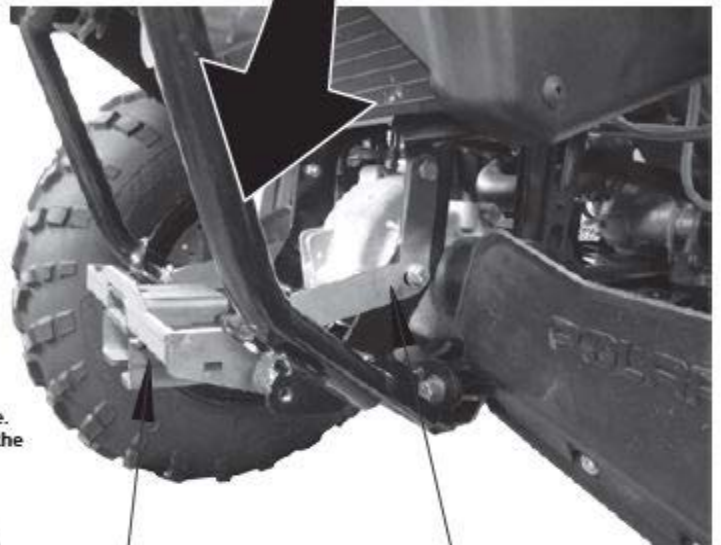

Support brackets bolt to the outside of the frame brackets.

Mount slides over the towhook loop.



Front plastic BEFORE cutting.

Front plastic AFTER cutting.

**FOR QUESTIONS OR COMMENTS PLEASE CALL: 320-964-1616 (7:00 to 4:30 CST Monday through Thursday).**