



RM4 Plow Mount Installation Instructions

2011 650I Brute Force / 05-17 750 Brute Force

PART# 4501-0766

Parts highlighted are pre-installed in push tube.

ITEM	QTY.	PART#	DESCRIPTION
1	1	2584-100	Main Mount Plate
2	1	KD100	Removable Mount
3	2	2584-104	Fairlead Support Brackets
4	2	HDW7078	1/2 Nut
5	2	HDW9110	1/2 x 2 Hex Bolt (full thread)
6	1	HDW9185	1/2 x 1-1/2 Cotterless Hitch Pin
7	4	HDW2150	5/16 x 1-1/8 x 1-3/4 Rd. U-Bolt
8	10	HDW9002	5/16 Flat Washer
9	10	HDW7058	5/16 Nylock Nut
10	2	HDW9199	1/4 x 3/4 x 1-1/2 Rd. U-Bolt
11	4	HDW9012	1/4 Flat Washer
12	4	HDW7050	1/4 Nylock Nut
13	2	HDW2061	5/16 x 1-1/4 Hex Bolt

The RM4 Mount kit is designed to allow for quick removal when not needed for plowing. This mount design uses the machines front bumper and frame member to push against and distribute the load when plowing. See below for installation instructions of the mount kit. NOTE: This RM4 mount will fit with both the Moose winch mount kit and the Kawasaki (US Only) winch mount kit. If you are experiencing difficulties installing with another brand of winch mount we recommend purchasing a Moose winch mount.

INSTALLATION:

1. Remove the lower front plastic skidpan. The RM4 permanent mount (#1) will back up to the short horizontal frame tube in back and the front of the winch mount (at the roller fairlead). The two angled support braces will attach to the bumper support tubes with u-bolts. See Illustration.
2. Install your winch and winch mount if not already installed but remove the roller fairlead.
3. Slide the two 1/4" x 3/4" x 1-1/2" u-bolts (#10) around the back of the short horizontal frame tube facing forward. Slide the mount in place from the front of the machine. The u-bolts should slide through the lower holes in the mount, the two upper tabs will line up with the roller fairlead holes in the winch mount, and the two support brackets will rest on top of the bumper support tubes. Loosely secure the lower u-bolts to the mount with four 1/4" flat washers (#11) and 1/4" nylock nuts (#12). See Illustration.
4. Slide a 5/16" x 1-1/8" x 1-3/4" u-bolt (#7) over each bumper support tube (right in front of each metal bumper bracket) and loosely bolt in place to the support brackets of the RM4 mount. Loosely secure with four 5/16" flat washers (#8) and 5/16" nylock nuts (#9).
5. The two roller fairlead support straps (#3) bolt to the back of the winch mount (at the roller fairlead) and go straight up to a horizontal bumper tube. Secure at the top to the bumper tube with two 5/16" x 1-1/8" x 1-3/4" u-bolts (#7), four 5/16" flat washers (#8) and 5/16" nylock nuts (#9). Next secure everything at the roller fairlead. Using two 5/16" x 1" hex bolts (#13) from the front, bolt through the roller fairlead, RM4 mount, winch mount, and roller fairlead support straps. Loosely secure with two 5/16" nylock nuts (#9) and 5/16" flat washers (#8). Make sure the mount is straight and tighten all nuts and bolts.
6. You will need to trim the lower plastic skidpan for clearance with the RM4. Hold the skidplate in place and mark the area that will need to be trimmed out for the mount and receiver to fit. Use a sharp knife, hacksaw, or other cutting tool to cut out the skidpan. You will have to remove the center two mounting holes. Reinstall the skidpan using the remaining four holes.

FOR QUESTIONS OR COMMENTS PLEASE CALL: 320-964-1616 (7:00 to 4:30 CST Monday through Thursday).



RM4 Plow Mount Installation Instructions

2011 650I Brute Force / 05-17 Brute Force 750
PART# 4501-0766

Page 2

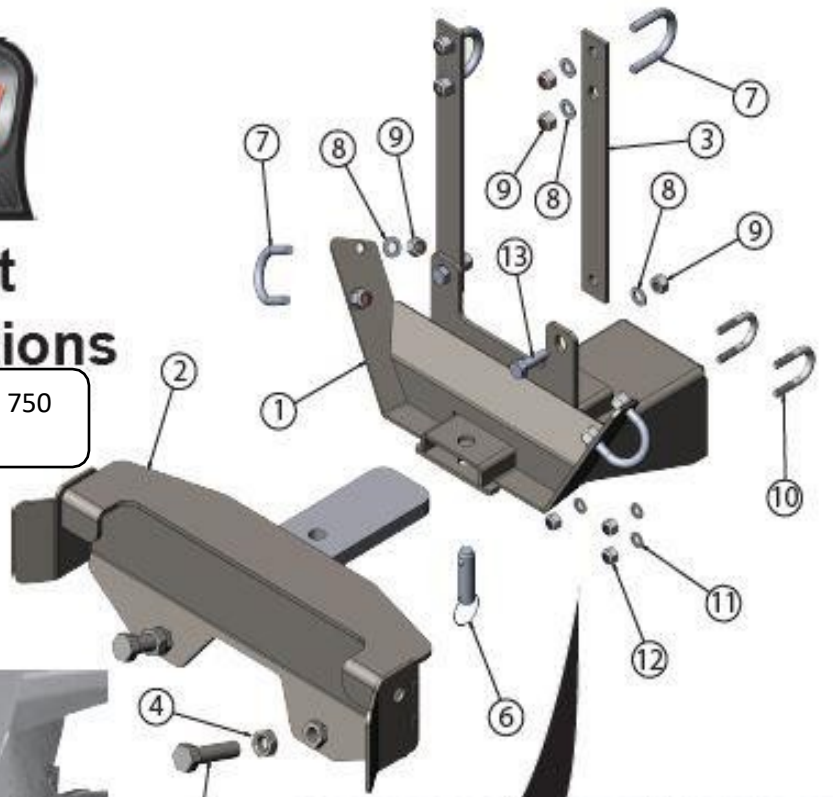

Roller fairlead support straps attach around a horizontal bumper tube behind the front plastic grille.



The side supports of the RM4 mount u-bolt around the bumper tubes



Front plastic BEFORE cutting.



Front plastic AFTER cutting.



The front of the RM4 will bolt to the winch mount plate. Use two 5/16" x 1" bolts to secure the roller fairlead, RM4 mount, winch mount, and roller fairlead support brackets.

U-bolt the back of the mount around the short horizontal frame tube.