



RM4 PLOW MOUNT INSTRUCTIONS

2017 Ranger 1000XP & Crew / Diesel HST

PART# 4501-0804

2018 Ranger 900XP / 13-17 Ranger 900 & Crew

2016 Ranger 570 Full Size

ITEM	PART#	QTY.	DESCRIPTION
1	2482-100	1	RM4 Plow Mount Weldment
2	KD200	1	Removable Mount
3	HDW2210	4	7/16 x 1 Hex Bolt
4	HDW7084	4	7/16 Nylock Nut
5	HDW9185	1	1/2 Cotterless Hitch Pin

The RM4 Mount kit is a two piece design to allow for quick removal when not needed for plowing. The retractable pins on the push tube that extend into either side of the mount are to keep the plow in place on the machine and do not take the plowing force, they just hold the plow in position. See below for installation instructions of the mount kit.

NOTE: This RM4 mount will fit with the Moose winch mount kit and the Polaris winch mount kit. If you are experiencing difficulties installing with another brand of winch mount we recommend purchasing a Moose winch mount.

NOTE: The pulley kit (Part #4501-0699) is required for easier raising/lowering of the plow system using your winch.

INSTALLATION:

1. Install your winch and winch mount to the machine.
2. Remove the two lower bolts on the front bumper. See illustration to verify which bolts.
3. Locate the four open holes in the front of the steel factory bumper. Hold the RM4 in position lining up these holes. Loosely bolt in place using the four 7/16" x 1" hex bolts (#3) and nylock nuts (#4). Reinstall the factory bolts removed in step 2 through the bottom of the RM4 mount and into the machine.
4. Once all bolts are in place and started you can tighten the hardware.

The 1/2" bolts and nuts in the removable mount are now located in the push tube box.

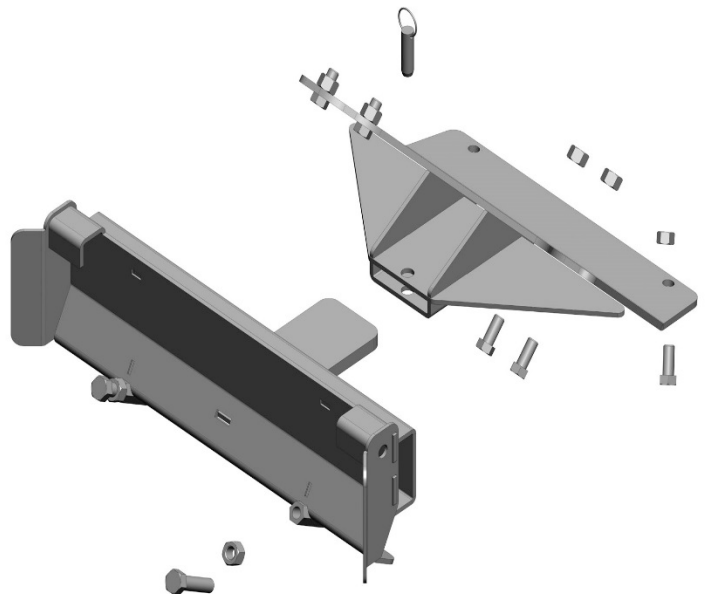

FOR QUESTIONS OR COMMENTS PLEASE CALL: 320-964-1616 (7:00 to 4:30 CST Monday through Thursday).

INST2482PF