



RM4 PLOW MOUNT INSTRUCTIONS

14-17 Honda 700 / 500 Pioneer
 14-16 Honda 700 Pioneer 4-Seater

PART# 4501-0765

ITEM	PART#	QTY.	DESCRIPTION
1	2489-100	1	RM4 Plow Mount
2	KD200PF	1	Removable Mount
3	HDW1069	2	10mm x 30mm Hex Bolt
4	HDW2145	2	3/8 x 2 x 3 Rd. U-Bolt
5	HDW7061	4	3/8 Nylock Nut
6	HDW9001	4	3/8 Flat Washer
7	HDW9185	1	1/2 x 1-1/2 Cotterless Hitch Pin

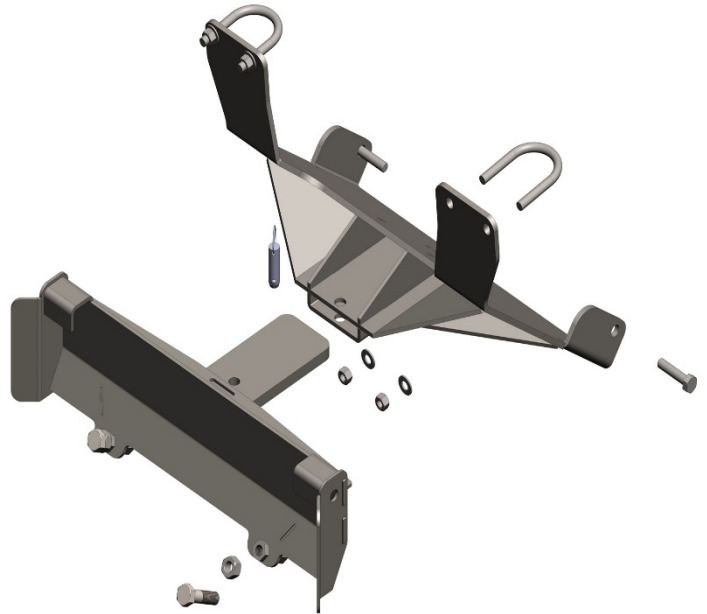
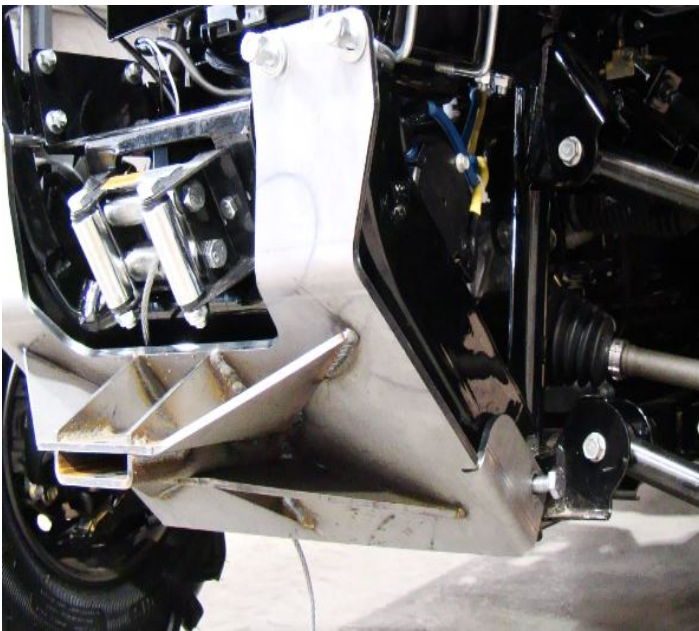

1. Remove the lower front skid plate bolts on each side of the machine.
2. Slide the U-bolts around the bumper tubes (just above the bumper support arms) at the top of the skid pan.
3. Install the mount onto the U-bolts using the washers/nylock nuts to lightly secure.
4. Attach the lower portion of the mount to the lower skid plate (where you removed the bolts from) using the 10mm x 30mm hex bolts. Once hardware is in place, tighten securely.
5. Slide the removable mount in place and use the cotterless hitch pin to secure. You are now ready to attach the push tubes.
6. The droop stop bolts, shown in the removable mount, are now pre-assembled into the push tube.
7. The RM4 mounts are designed to be used with a Moose winch mount.

FOR QUESTIONS OR COMMENTS PLEASE CALL: 320-964-1616 (7:00 to 4:30 CST Monday through Thursday).

INST2489PF