

INSTALLATION INSTRUCTIONS

DRAG SPECIALTIES FUEL DOOR LATCH KIT P/N 0703-0631/0632

ATTENTION INSTALLER (if other than owner): Please forward this instruction sheet to the purchaser of this product. These instructions contain valuable information necessary to the end user.

INTRODUCTION: These instructions describe the procedure for properly installing the Drag Specialties fuel door latch kit for 92-14 FLHT, FLTR, FLT, FLHX and FLHR models. Review these instructions carefully before beginning, as they contain valuable information. Please retain for future reference.

Particularly important information is distinguished in these instructions by the following notations:

NOTE: A NOTE provides key information to make procedures easier or clearer.

CAUTION: A CAUTION indicates special procedures that must be followed to avoid damage to the motorcycle and/or accessories.

WARNING!: A WARNING indicates special procedures that must be followed to avoid injury to a motorcycle operator or person inspecting or repairing the motorcycle.

TOOLS REQUIRED:

1/4" Combination wrench
7/8" Combination wrench

1. Open the fuel door. Using the 7/8" open end wrench, remove the stock lock and nut from the fuel door.
2. **SEE FIG. 1.** Install the push-button lock and nut on the fuel door. Confirm that it is orientated correctly. Tighten the nut using caution.

FIG. 1

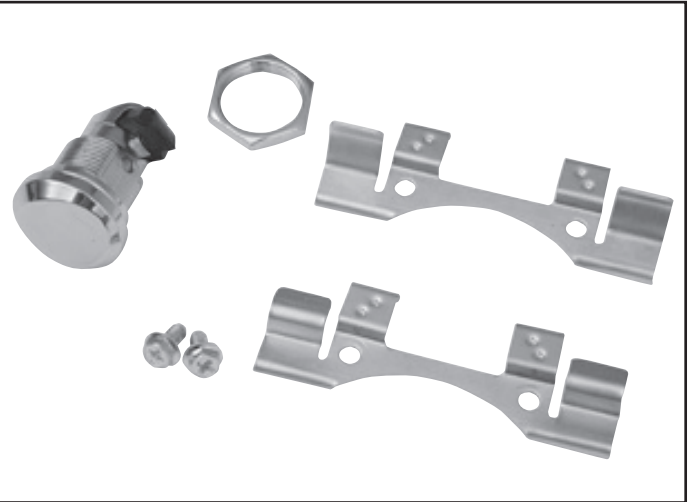
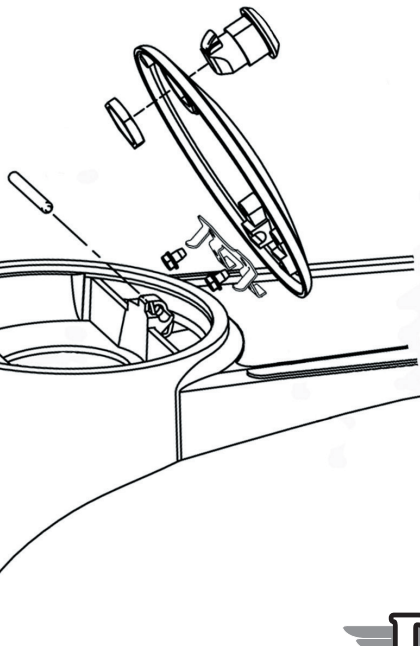

3. Remove the two screws using the 1/4" wrench and replace the stock hinge mounting clip with the correct hinge mounting clip from the kit for your year of bike (**SEE FIG. 2**). Reinstall the stock screws.

FIG. 2



USE ON 1992-2007 MODELS ONLY



USE ON 2008-2014 MODELS ONLY

CAUTION: Use caution when tightening the screws, as it is easy to strip the threads.

4. Close the fuel door. A small amount of pressure will be needed to close the fuel door because it is now spring loaded.

NOTE: Occasionally spray the lock assembly with a lubricant to keep it working smoothly.

WARNING!: Before operating the motorcycle, be sure all of the hardware is tight.

