

**Fi2000**



## FI2000 POWRPRO WITH CVT TECHNOLOGY

- CVT – Continuously Variable Tuning is the key to the remarkable performance the Fi2000 PowrPro delivers
- PowrPro uses electronic control technology that calculates the bike's rate of acceleration by reading crankshaft rotation at the flywheel and changes in load just as a dynamometer measures acceleration at the rear wheel
- PowrPro measures and adjusts fuel flow during acceleration to the injectors in microseconds for super-fast fuel tuning – continuously and automatically; net result: precise EFI tuning now happens in the real world in real time, nonstop, up to 80 times per second
- New patented technology unlike any other system on the market
- PowrPro tunes to precise air-fuel mixture to create maximum power 80 times per second (does not tune to a predetermined arbitrary AFR)
- Creates that adjustment to maximum power on every squirt of the injector
- It's like having the best custom map writing, dyno operator tuning your fuel every time you crank the throttle
- Tunes every gear, every roll on, every environmental change, every engine mod, lugging the engine, winding it out to redline: it reacts, verifies, and adjusts when the bike is accelerating
- Provides perfect acceleration fuel settings in any condition, with any exhaust system with any engine modifications
- No matter what kind of new hardware you install on your bike--a new exhaust system, a freer-flowing air filter setup or even a big-bore hop-up kit with high-performance cams, PowrPro continues to analyze and tune your engine for peak performance
- No external adjustments needed
- No dyno needed
- No additional components needed
- Does not require wide band oxygen sensors



NOTE: Not legal for operation on public highways in the state of California.

PART #	DESCRIPTION	SUG. RETAIL	PART #	DESCRIPTION	SUG. RETAIL
1020-1553	For 12 FXS/FLST	\$599.95	1020-1551	For 12 Dyna Glide	\$599.95



**Fi2000**



## FI2000R O<sub>2</sub> FUEL PROCESSOR

- The Fi2000R O<sub>2</sub> digital fuel processor is designed to work with all H-D exhaust systems (stock or aftermarket) equipped with oxygen sensors in place (closed-loop design)
- Works much like a carburetor jet kit with adjustments similar to the air-mixture screw, the needle and clip positions and the main jet
- The Fi2000R increases horsepower and torque by optimizing stock lean air/fuel mixtures (helps cool the engine temps as well)
- Quick and simple installation with plug-and-ride technology with OEM-style connectors
- No confusing computer downloads to install
- No expensive dyno-testing required
- Pre-configured from the factory for your make and model, but easy to adjust should your specific application need it
- Improves overall rideability

NOTE: Standard models not legal for operation on public highways in the state of California.

NOTE: C.A.R.B. E.O. # D-633-1.



**Low-Speed Screw**  
This control functions similar to the air mixture screw on a carburetor, controlling off-idle fuel demands and steady cruising.

**Mid-Speed Screw**  
This is the equivalent of the needle and clip position on a carburetor. Two increments correspond to dropping the clip on a needle one position. One increment is the same as adding a shim. This is where you get the proper fuel mixture under load and acceleration.

**High-Speed Screw**  
This is the electronic counterpart to your main jet. Each numbered increment is the same as going up one main jet size starting with the stock size at zero. This adjusts your fuel at full throttle.

PART #	DESCRIPTION	SUG. RETAIL	PART #	DESCRIPTION	SUG. RETAIL
<b>STANDARD</b>			<b>CALIFORNIA</b>		
1020-1554	For 12 FXS/FLST	\$279.95	1020-1550	For 12 FXS/FLST	\$279.95
1020-1552	For 12 Dyna Glide	279.95	1020-1549	For 12 Dyna Glide	279.95



1800-1416



1800-1417



## SHORTSHOTS STAGGERED

- A revolution in blue-proof exhaust technology, Vance & Hines delivers the short, fat, straight-pipe look with twin slash-cut ends
- High style and performance combined with unbeatable value
- 1<sup>3</sup>/<sub>4</sub>" headpipes with 220° coverage heat shields
- Includes removable baffles, mounting hardware and instructions
- Black pipes feature full coverage heat shields coated with a race-quality black ceramic contrasted with a signature chrome badge and end tips
- Made in the U.S.A.

PART #	DESCRIPTION	SUG. RETAIL
<b>FOR 12 DYNA MODELS</b>		
<b>1800-1416</b>	Chrome	<b>\$384.95</b>

PART #	DESCRIPTION	SUG. RETAIL
<b>FOR 12 DYNA MODELS (CONT)</b>		
<b>1800-1417</b>	Black	<b>\$464.95</b>



## WOOF PAK™

- Add the missing bass everyone craves with this clean system
- Integrated drop-in subwoofer system is designed to fit into H-D's King and Ultra Tour-Paks®
- Form-fitted, sealed enclosure featuring JL Audio's perfectly matched 8" 8W1 subwoofer and XD200 amplifier
- Simple plug-and-play wire harness works with any audio system installed on your bike
- Includes port grommet, port block-off plate, grommet support ring and complete installation instructions
- Made in the U.S.A.

NOTE: Installation requires cutting a sound port in the front of the Tour-Pak®.

PART #	DESCRIPTION	SUG. RETAIL
<b>4405-0235</b>	Woof Pak™ subwoofer system	<b>\$699.95</b>



Made for  
iPod iPhone

## DASHLINK™ INTEGRATED FUEL TANK CONSOLE/ DOCKING STATION FOR iPhone®/iPod TOUCH®

- DashLink™ integrates a complete docking station for iPhone/iPod touch into a sweet replacement fuel tank console for your Harley
- Smart charging system with self-sensing on/off circuit to detect when a device is present
- Audio out circuit using line-level output
- Clean "wire-free" appearance
- FLHT/FLHX models feature volume up/down control through stock handlebar controls
- iPod touch/iPhone registered trademarks of Apple, Inc.

PART #	DESCRIPTION	SUG. RETAIL
<b>CHROME</b>		
<b>2201-0136</b>	For 96-07 FLHTCU	<b>\$399.95</b>
<b>GLOSS BLACK</b>		
<b>2201-0130</b>	For 08-12 FLHT, FLHX and FL Trike models	<b>\$399.95</b>
<b>2201-0132</b>	For 08-12 FLHR and Softail models (except FXS)	<b>\$399.95</b>
<b>2201-0138</b>	For 96-07 FLHTCU	<b>\$399.95</b>



2201-0130



**ACCUTRONIX**

*Our friends at Accutronix have been manufacturing some of the highest quality motorcycle products on the market for about as long as we can remember. These folks will tell you that they are committed to delivering high-end, top-quality craftsmanship in unique custom items that fit right, function flawlessly and of course look great. Here now are some of their latest offerings.*

**GAUGE MOUNT ADAPTER**

- CNC billet aluminum with a black finish
- Designed to adapt FXD and XL OEM gauge mount to 1 1/4" and 1 1/2" T-bars
- Made in the U.S.A.

NOTE: Not for 883C/1200C/1200X XL models.



PART #	DESCRIPTION	SUG. RETAIL	PART #	DESCRIPTION	SUG. RETAIL
<b>2210-0237</b>	For 1" T-bar handlebars	<b>\$111.95</b>	<b>2210-0236</b>	For 1 1/4" T-bar handlebars	<b>\$111.95</b>
<b>2210-0238</b>	For 1 1/2" T-bar handlebars	<b>111.95</b>			

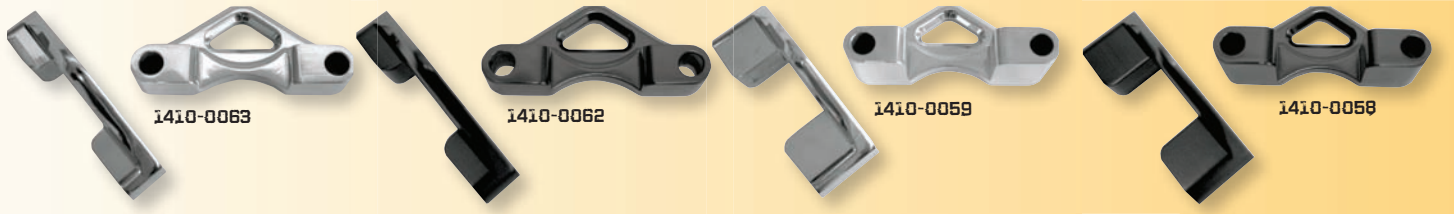

**"HOT LEGS" / "BAGGER LEGS" FENDER SPACERS**

- Designed to be used with Arlen Ness "Hot Legs" lower legs, American Suspension "Bagger Legs" lower legs or stock lower legs
- .8125" spacers can be used with custom fenders for 26" wheels
- 1" spacers can be used with custom fenders for 23" wheels
- 1.25" spacers can be used with custom fenders for 21" wheels
- Sold in pairs
- Made in the U.S.A.

NOTE: For custom applications, measure fender as custom fenders vary in width.



PART #	DESCRIPTION	SUG. RETAIL	PART #	DESCRIPTION	SUG. RETAIL	PART #	DESCRIPTION	SUG. RETAIL
<b>FOR 84-12 FLT/FLHT AND H-D FL TRIKE</b>			<b>FOR 84-12 FLT/FLHT AND H-D FL TRIKE (CONT)</b>			<b>FOR 84-12 FLT/FLHT AND H-D FL TRIKE (CONT)</b>		
<b>.8125" SPACERS</b>			<b>1" SPACERS</b>			<b>1.25" SPACERS</b>		
<b>1410-0063</b>	Chrome	<b>\$107.95</b>	<b>1410-0059</b>	Chrome	<b>\$107.95</b>	<b>1410-0061</b>	Chrome	<b>\$107.95</b>
<b>1410-0062</b>	Black	<b>107.95</b>	<b>1410-0058</b>	Black	<b>107.95</b>	<b>1410-0060</b>	Black	<b>107.95</b>

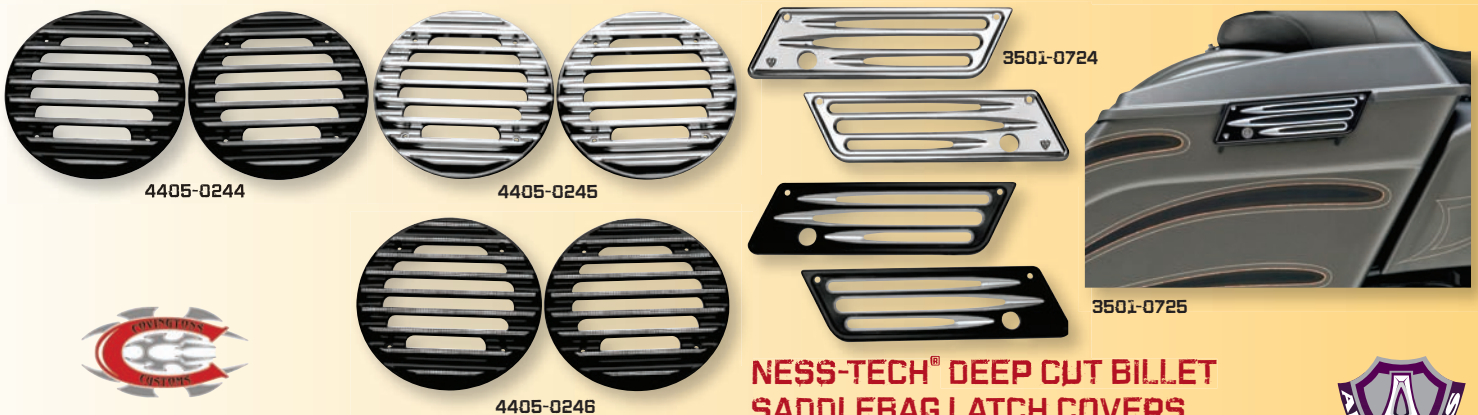

**REAR SPEAKER GRILLES**

- CNC-machined billet aluminum construction
- Sold in pairs
- Made in the U.S.A.

PART #	DESCRIPTION	SUG. RETAIL
<b>FOR 99-12 FLHTCU/FLHTCUTG MODELS</b>		
<b>4405-0244</b>	Gloss black powdercoat	<b>\$289.95</b>
<b>4405-0245</b>	Chrome	<b>289.95</b>
<b>4405-0246</b>	Black diamond edge	<b>499.95</b>

**NESS-TECH® DEEP CUT BILLET SADDLEBAG LATCH COVERS**

- Machined from 6061-T6 billet aluminum
- Unique and clean style
- Latch covers replace the factory faceplates while retaining all functions of the stock latches
- Sold in pairs

PART #	DESCRIPTION	SUG. RETAIL
<b>FOR 93-12 DRESSER MODELS</b>		
<b>3501-0724</b>	Chrome	<b>\$189.95</b>
<b>3501-0725</b>	Black	<b>189.95</b>





## ROLAND SANDS DESIGN

*"RSD" is still On-The-Gas! The new Clarity line of products is a huge success as are the new apparel offerings from Roland. But it does not stop there. Almost as fast as we can create new flyers and catalogs, there are new parts and accessories rolling out of RSD. Take a look at the new clutch and brake levers here that combine performance and style into a one-of-a-kind easy upgrade. Have them on hand for your customers.*



## VELOCITY STACKS

- CNC machined from billet aluminum
- Bolts directly to S&S Super E or G carb
- No backing plate required
- Chrome bolts and gasket included
- Made in the U.S.A.

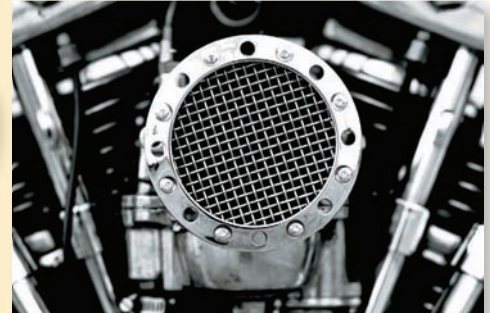

NOTE: Breather systems must be purchased separately for models requiring one.

PART #	DESCRIPTION	SUG. RETAIL	PART #	DESCRIPTION	SUG. RETAIL
<b>FOR S&amp;S E AND G CARBS</b>			<b>FOR S&amp;S E AND G CARBS (CONT)</b>		
<b>1010-1033</b>	Black	<b>\$189.95</b>	<b>1010-1034</b>	Chrome	<b>\$199.95</b>



## REGULATOR CLUTCH AND BRAKE LEVERS

- Race-styled stock replacement levers add an aggressive look to your stock OEM master cylinders
- CNC machined from billet aluminum
- Lever surface shape designed for a comfortable and smooth feel
- Laser-engraved RSD logo
- Regulator style features twist adjuster that easily modifies lever distance from handlebar
- Available in chrome, Contrast-Cut or Black Ops
- Contrast Cut™ finish starts with a polished lever that has been black anodized, then recut to open the design
- Black Ops™ features gloss black on top of contrasting textured black for outstanding durability and good looks
- Sold as brake/clutch lever sets



PART #	DESCRIPTION	SUG. RETAIL	PART #	DESCRIPTION	SUG. RETAIL	PART #	DESCRIPTION	SUG. RETAIL
<b>FOR 96-12 BIG TWIN, 96-03 XL (EXCEPT 08-12 FLHT/FLHR/FLTR/FLHX/H-D FL TRIKE)</b>			<b>FOR 08-12 FLHT/FLHR/FLTR/FLHX AND H-D FL TRIKE</b>			<b>FOR 04-12 XL</b>		
<b>0610-0608</b>	Chrome	<b>\$159.95</b>	<b>0610-0605</b>	Chrome	<b>\$159.95</b>	<b>0610-0611</b>	Chrome	<b>\$159.95</b>
<b>0610-0609</b>	Contrast Cut	<b>159.95</b>	<b>0610-0606</b>	Contrast Cut	<b>159.95</b>	<b>0610-0612</b>	Contrast Cut	<b>159.95</b>
<b>0610-0610</b>	Black Ops	<b>194.95</b>	<b>0610-0607</b>	Black Ops	<b>194.95</b>	<b>0610-0613</b>	Black Ops	<b>194.95</b>



## CHRONO GRIPS

- CNC machined from billet aluminum or machined brass
- Custom knurled RSD logo rubber sleeves
- Interchangeable RSD logo badges on end caps
- Matching Chrono foot pegs and shifter pegs available separately.
- Available in chrome, brass, Contrast-Cut or Black Ops finishes
- Contrast Cut™ finish starts with a polished grip that has been black anodized, then recut to open the design
- Black Ops™ features gloss black on top of contrasting textured black for outstanding durability and good looks
- Sold in pairs



PART #	DESCRIPTION	SUG. RETAIL	PART #	DESCRIPTION	SUG. RETAIL
<b>FOR ALL 84-12 MODELS (EXCEPT 08-12 DRESSERS, H-D FL TRIKE)</b>			<b>FOR 08-12 FLHT/FLHR/FLHX/FLTR, H-D FL TRIKE</b>		
<b>0630-1014</b>	Chrome	<b>\$119.95</b>	<b>0630-1017</b>	Chrome	<b>\$159.95</b>
<b>0630-1015</b>	Contrast Cut	<b>119.95</b>	<b>0630-1018</b>	Contrast Cut	<b>159.95</b>
<b>0630-1016</b>	Black Ops	<b>149.95</b>	<b>0630-1019</b>	Black Ops	<b>189.95</b>
<b>0630-1020</b>	Brass	<b>175.95</b>	<b>0630-1021</b>	Brass	<b>175.95</b>



### SPORTSTER CAFE RACER SEAT

- Clean, comfortable and custom-detailed seat combines the simple lines of a cafe tail with the tank and frame rails of the stock HD Sportster
- Perforated number plate and seat area
- 11" W front seat; 5.5" W rear area
- Black vinyl deep seating area with RSD steel eagle badge
- Made in the U.S.A.

NOTE: Will also fit Sportster 48 with 2.1 gallon tank, but will leave a gap between the seat nose and tank.

NOTE: Rear portion of the seat is for decoration only; not for passenger use.



PART #	DESCRIPTION	SUG. RETAIL
<b>FOR 04-12 XL W/ 3.3 GAL. TANK</b>		
<b>0804-0437</b>	Cafe racer solo seat	<b>\$399.95</b>



### BUTTCRACK™ SOLO

- The name says it all
- Designed to fit the contours of a rider's body, this seat cups them into the saddle for a true custom feel
- The carved leg passage allows for unobstructed movement
- The one-piece all-leather cover wraps the complete seat
- Matching pillion pads sold separately
- Made in the U.S.A.



PART #	DESCRIPTION	SUG. RETAIL
<b>FOR 06-12 DYNA GLIDE</b>		
<b>0803-0370</b>	Plain smooth seat	<b>\$278.95</b>
<b>0803-0371</b>	Flame stitch seat	<b>299.95</b>
<b>0803-0372</b>	French seam stitch seat	<b>299.95</b>

PART #	DESCRIPTION	SUG. RETAIL
<b>FOR 06-12 DYNA GLIDE (CONT)</b>		
<b>0803-0373</b>	Plain smooth pillion pad	<b>\$142.95</b>
<b>0803-0374</b>	French seam stitch pillion pad	<b>163.95</b>



### TECH SERIES SEAT PADS

- Incorporates thin space-age micro-spacer fabric with Pro Pad polymer for improved airflow
- An improved version of the Pro Pad polymer insert features a cutout along the middle to reduce pressure along with holes along the outer area to promote airflow
- Features a non-slip bottom
- Includes straps with hooks for easy installation

PART #	DESCRIPTION	SUG. RETAIL
<b>0807-0140</b>	Small, 7.5" W x 11" L	<b>\$49.95</b>
<b>0807-0138</b>	Medium, 15" W x 11" L	<b>79.95</b>
<b>0807-0139</b>	Large, 16" W x 13" L	<b>89.95</b>

PART #	DESCRIPTION	SUG. RETAIL
<b>0807-0141</b>	X-large, 17" W x 17" L	<b>\$99.95</b>
<b>0807-0142</b>	Touring, 16.5" W x 15" L	<b>104.95</b>

## KLOCK WERKS

Of course your customers are seeing a lot of the new Billboard Flare windshields out on the road. Now Brian Klock and his team have come up with a stylish way for you to put these hot sellers in front of your customers right in your showroom. Talk to your rep today for further information on this "Try It Before You Buy It" offering and watch your windshield sales soar.



2320-0095

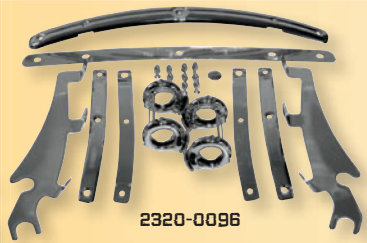

2320-0096



## WINDSHIELD MOUNTING KITS

- Brilliant high-quality chrome finish
- Includes all brackets, cross bracing and hardware to mount Flare™ plastic or most OEM accessory windshields

PART #	DESCRIPTION	SUG. RETAIL
2320-0095	For 86-12 FLST/C, 93-96 FLSTN, 05-12 FLSTN, 90-12 FLSTF with OEM accessory detachable king-size windshield	\$209.95
2320-0096	For 85-10 FXST (except FXSTs and FXCW/C), 00-07 FXSTD, 93-05 FXDWG, 80-85 FXWG and other wide (41mm) forks with OEM accessory detachable compact windshield	209.95
2320-0097	For 88-12 XL (except 11-12 XL883L/XL1200X/XL1200C); 91-95 FXD (except 93-05 FXDWG), 88-99 FXR, 99-00 FXR 2/3/4 and other narrow (39mm) forks with OEM accessory detachable compact windshield	209.95



2040-0994



2040-0995



2040-0996



## 1" TURN SIGNALS

- CNC-machined billet aluminum with black finish
- Housing is internally threaded with a screw-on bezel
- Vibration isolation for long bulb life
- Hornet model features 1", single-filament 20W MR8 halogen bulbs, amber lenses and 5/16" mounting bolt
- Easy-to-install E-Z Plug™ connectors
- Wiring on Hornet models is concealed through a bugle base stem with a hollow 5/16" mounting bolt
- Revolver rocket and Revolver Mariah models feature single-filament MR11, 20W halogen bulbs, amber lenses and 5/16"-24 hex-head cap screws that have been drilled for wire feed
- Sold in pairs

PART #	DESCRIPTION	SUG. RETAIL
2040-0994	Hornet turn signals, black	\$208.95
2040-0995	Revolver rocket turn signals, black	199.95
2040-0996	Revolver Mariah turn signals, black	219.95



## BILLBOARD FLARE WINDSHIELD DISPLAY

- "Try It Before You Buy It" display puts Billboard windshields where your customers can see them, and TRY THEM as well
- Display holds one Billboard Windshield with the included hardware
- Contact your Sales Rep. for further information

PART #	DESCRIPTION	SUG. RETAIL
9903-0355	Display	-



2001-0620



2001-0619

## 4 1/2" LIGHT HOUSINGS

- Spun billet aluminum push-formed construction
- Features a threaded headlight locking ring
- Accepts halogen or sealed beam lights; sold separately; see 2012 FATBOOK
- Required headlight blocks/posts are sold separately
- Made in the U.S.A.



NOTE: Check clearance between frame and headlight housing before mounting.

NOTE: Sold as housing only. No bulb or glass included.

PART #	DESCRIPTION	SUG. RETAIL
2001-0620	Concours rocket, black	\$229.95
2001-0619	Mariah concurs rocket, black	259.95

## FALCON

- Unique design combines classic styling of American vintage cruiser shield with features like size and hand protection from a classic touring shield
- Upper fork mounting system with a show-quality, triple-chrome-plated finish
- DOT approved
- Made in the U.S.A.

*slip streamer inc.*



2313-0118

PART #	DESCRIPTION	SUG. RETAIL
<b>FOR 29-41MM WIDE GLIDE FORK TUBES (11"-12.5" FORK SPAN)</b>		
2313-0112	16" clear	\$259.95
2313-0113	20" clear	274.95

PART #	DESCRIPTION	SUG. RETAIL
<b>FOR 42-58MM FAT FORK TUBES (9"-10.5" FORK SPAN)</b>		
2313-0118	16" clear	\$259.95
2313-0119	20" clear	274.95

*slip streamer inc.*

## CLASSIC WINDSHIELDS

- Complement your cruiser's style with this sleek design
- Upper fork mounting system with a show-quality, triple-chrome-plated finish
- DOT approved
- Made in the U.S.A.



2313-0115



2313-0116

PART #	DESCRIPTION	SUG. RETAIL
<b>FOR 28-41MM WIDE GLIDE FORK TUBES (11"-12.5" FORK SPAN)</b>		
2313-0108	17" clear	\$241.95
2313-0109	17" smoke	245.95
2313-0110	22" clear	256.95
2313-0111	22" smoke	262.95

PART #	DESCRIPTION	SUG. RETAIL
<b>FOR 42-58MM FAT FORK TUBES (9"-10.5" FORK SPAN)</b>		
2313-0114	17" clear	\$241.95
2313-0115	17" smoke	245.95
2313-0116	22" clear	256.95
2313-0117	22" smoke	262.95

*slip streamer inc.*

## SPITFIRE

- 1" handlebar mount fairing; chrome hardware included
- Distinctive looks and streamlined protection in a small fairing
- Fully adjustable; mounts/dismounts in seconds
- Dimensions: 15" H x 17 1/2" W
- Made in the U.S.A.

PART #	DESCRIPTION	SUG. RETAIL	PART #	DESCRIPTION	SUG. RETAIL
2313-0120 <sup>1</sup>	Clear	\$86.95	2313-0121 <sup>1</sup>	Tint	\$86.95

<sup>1</sup> Include spacers to work with 7/8" or 1" bars.



2313-0121



2010-0827



2010-0828

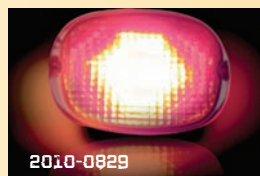

2010-0829



2010-0830



2010-0831



2010-0832

## LED INTEGRATED LAYDOWN-STYLE TAILLIGHTS

- 84 dual-intensity Genesis II Red LEDs for running and brake light functions
- 36 Amber Genesis II LEDs for turn signal function (on select styles)
- White license plate illumination in window
- Plug-and-play direct replacement for all HDs equipped with an OEM squareback taillight
- Non DOT Approved

**FOR 99-12 H-D MODELS (EXCEPT V-ROD, FXSTO AND MODELS EQUIPPED WITH TOMBSTONE TAILLIGHTS)**

PART #	DESCRIPTION	SUG. RETAIL	PART #	DESCRIPTION	SUG. RETAIL
<b>NO WINDOW</b>			<b>WITH WINDOW</b>		
2010-0827	Red	\$149.95	2010-0830	Red	\$149.95
2010-0828	Smoke	149.95	2010-0831	Smoke	149.95
2010-0829	Smoke blackout	149.95	2010-0832	Smoke blackout	149.95



## LYNDALL RACING BRAKES

Paul Kittrell who founded Lyndall Racing Brakes back in 1998 used his background in race car brakes to develop some of the best brake pads available for H-D models. These days the folks at LRB are expanding their stopping power into rotors like the Millenium 20 Spoke and Lug Drive styles that you see here. Combined with their brake pads riders will realize great feel and unmatched braking in all conditions.

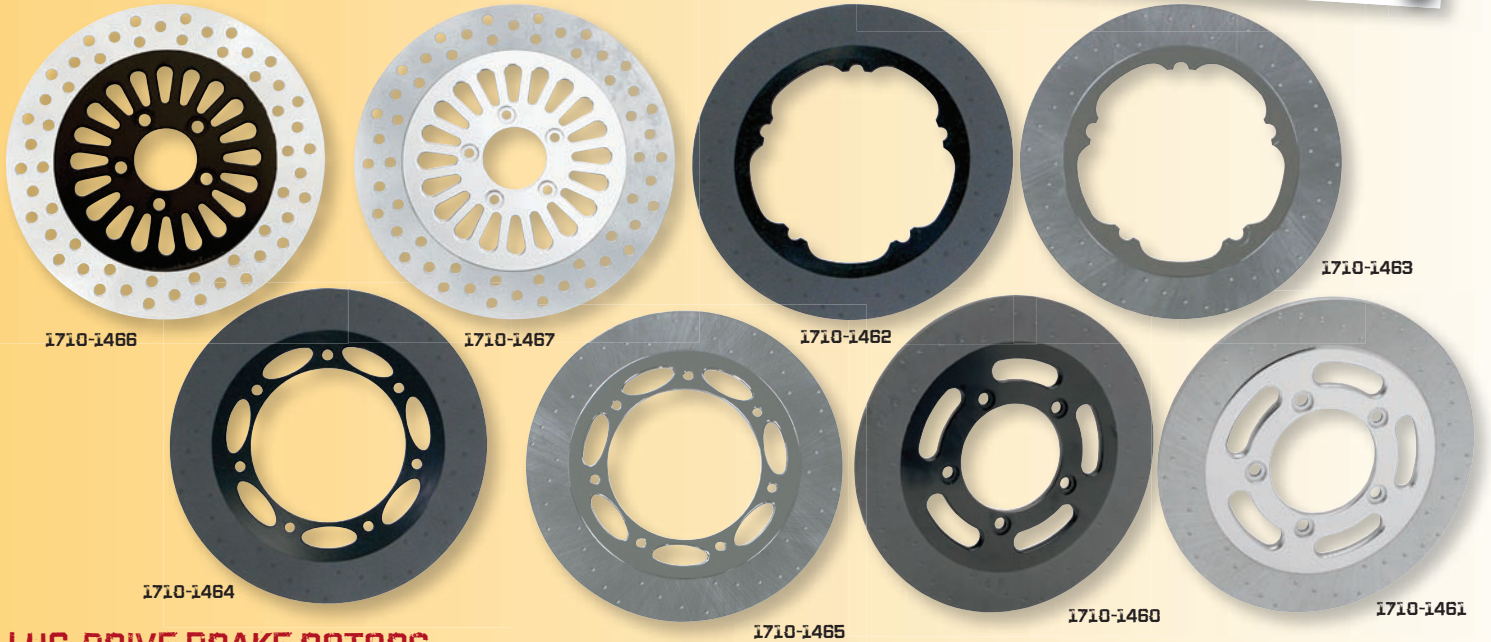

## LUG-DRIVE BRAKE ROTORS

- Friction ring is CNC-machined from satin-finish high carbon steel or from a lightweight aluminum-ceramic composite material
- Each rotor has a friction ring machined to fit flush with a carrier crafted from 6061 T-6 billet aluminum, locked together with a spiral retaining clip, giving the clean uninterrupted look of a solid rotor with the ultimate braking experience you can expect from a high performance fully-floating rotor by Lyndall Racing Brakes
- Available with chrome-plated or black anodized carrier
- For best results, use Lyndall Racing brake pads; see the Drag Specialties FatBook for applications
- Sold each
- Made in the U.S.A.

### FRONT

DESCRIPTION	SATIN FINISH HIGH CARBON STEEL FRICTION RING	SUG. RETAIL	COMPOSITE METAL FRICTION RING	SUG. RETAIL
<b>FOR 00-12 MODELS (EXCEPT 06-12 FLHT/FLHR/FLHX/FLTR, H-D FL TRIKE, V-ROD, SPRINGERS, 06-12 DYNA GLIDE) (11.5" DIA.)</b>				
Millennium 20 spoke, anodized black	<b>1710-1466</b>	<b>\$369.95</b>	-	-
Millennium 20 spoke, chrome	<b>1710-1467</b>	<b>369.95</b>	-	-
<b>FOR 08-12 FLHT, FLHR, FLHX, FLTR MODELS, H-D FL TRIKE MODELS, 06-12 DYNA MODELS (11.8" DIA.)</b>				
Millennium 20 spoke, anodized black	<b>1710-1470</b>	<b>369.95</b>	-	-
Millennium 20 spoke, chrome	<b>1710-1471</b>	<b>369.95</b>	-	-
<b>FOR 06-12 V-ROAD AND 06-08 SCREAMIN' EAGLE MODELS (300MM DIA.)</b>				
Lug Drive anodized black	-	-	<b>1710-1462</b>	<b>\$549.95</b>
Lug Drive chrome	-	-	<b>1710-1463</b>	<b>549.95</b>
<b>FOR 09-11 SCREAMIN' EAGLE MODELS (300MM DIA.)</b>				
Lug Drive, anodized black	-	-	<b>1710-1464</b>	<b>549.95</b>
Lug Drive, chrome	-	-	<b>1710-1465</b>	<b>549.95</b>

### REAR

DESCRIPTION	SATIN FINISH HIGH CARBON STEEL FRICTION RING	SUG. RETAIL	COMPOSITE METAL FRICTION RING	SUG. RETAIL
<b>FOR 00-12 MODELS (EXCEPT 08-12 FLHT/FLHR/FLHX/FLTR, H-D FL TRIKE, V-ROD, SPRINGERS) (11.5" DIA.)</b>				
Millennium 20-spoke, anodized black	<b>1710-1468</b>	<b>\$369.95</b>	-	-
Millennium 20-spoke, chrome	<b>1710-1469</b>	<b>369.95</b>	-	-
<b>FOR 08-12 FLHT, FLHR, FLHX, FLTR MODELS (EXC. H-D FL TRIKE) (11.8" DIA.)</b>				
Millennium 20-spoke, anodized black	<b>1710-1472</b>	<b>369.95</b>	-	-
Millennium 20-spoke, chrome	<b>1710-1473</b>	<b>369.95</b>	-	-
<b>FOR 06-12 V-ROD MODELS (300MM DIA.)</b>				
Lug Drive, black	-	-	<b>1710-1460</b>	<b>\$549.95</b>
Lug Drive, chrome	-	-	<b>1710-1461</b>	<b>549.95</b>





## FORK SPRING KIT

- The cost effective go-to for a substantial increase in front end ride quality
- Include Progressive Suspension rate springs combined with preload spacers
- Can improve front end stability and brake dive control as well as increase comfort for heavier riders or those looking for a firm high-performance feel out of their forks

PART #	DESCRIPTION	SUG. RETAIL	PART #	DESCRIPTION	SUG. RETAIL
<b>0405-0310</b>	For 09-12 H-D FL Trike	<b>\$109.95</b>	<b>0405-0309</b>	For 08-10 FXCW	<b>\$109.95</b>
<b>0405-0309</b>	For 06-08 FXDWG	<b>109.95</b>	<b>0405-0309</b>	For 08-11 FXCWC	<b>109.95</b>
<b>0405-0309</b>	For 10-12 FXDWG	<b>109.95</b>	<b>0405-0309</b>	For 02-06 VRSCA V-Rod	<b>109.95</b>
<b>0405-0309</b>	For 06-10 FXD	<b>109.95</b>	<b>0405-0309</b>	For 07-10 VRSCAW V-Rod	<b>109.95</b>
<b>0405-0309</b>	For 06-12 FXDB/C	<b>109.95</b>	<b>0405-0309</b>	For 06-08 VRSCD V-Rod	<b>109.95</b>
<b>0405-0309</b>	For 08-12 FXDF	<b>109.95</b>	<b>0405-0309</b>	For 07-11 VRSCDX V-Rod	<b>109.95</b>
<b>0405-0309</b>	For 06-11 FXDL	<b>109.95</b>			



0602-0513



0602-0514



## BRASS HANDLEBAR RISERS

- Made from CNC-machined billet solid brass
- Features a brushed machine finish
- Fit 1" handlebars
- Sold in pairs
- Made in the U.S.A.

PART #	DESCRIPTION	SUG. RETAIL
<b>0602-0513</b>	4" Glide-style risers w/ thru-hole	<b>\$249.95</b>
<b>0602-0514</b>	3" Post-style risers	<b>249.95</b>

## POLISHED BILLET D-RINGS

- CNC-sculpted billet aluminum
- Use with steel Valve Cover PART # DS-376503 or brass Valve Cover PART #s 0940-1068 and 0940-1069
- Available in polished finish
- Mounting screws not included
- Sold in pairs
- Made in the U.S.A.

PART #	DESCRIPTION	SUG. RETAIL
<b>0940-1071</b>	For 48-65 Panhead	<b>\$309.95</b>



0940-1069



0940-1068

## ROCKER COVERS

- Made from sheets of solid brass, not brass-plated
- Drawn and formed and polished to a bright finish; available in a smooth or ribbed design
- Sold in pairs
- Made in the U.S.A.

PART #	DESCRIPTION	SUG. RETAIL
<b>FOR 48-65 PANHEAD</b>		
<b>0940-1069</b>	Smooth, repl. OEM #17500-54	<b>\$291.95</b>
<b>0940-1068</b>	Ribbed	<b>291.95</b>



## BRASS DERBY COVER

- Made from sheets of solid brass, not brass-plated
- Drawn and formed and polished to a bright finish
- Made in the U.S.A.

PART #	DESCRIPTION	SUG. RETAIL
<b>1107-0254</b>	For 48-64 Panhead, 36-47 Knucklehead	<b>\$67.95</b>



## BRASS INSPECTION COVER

- Made from sheets of solid brass, not brass-plated
- Drawn and formed and polished to a bright finish
- Made in the U.S.A.

PART #	DESCRIPTION	SUG. RETAIL
<b>1107-0255</b>	For 48-64 Panhead, 36-47 Knucklehead	<b>\$27.95</b>



**CUSTOM  
REAR FENDER**

- Raw steel construction
- Pre-drilled to accept the OEM fender struts
- Requires custom mounting of the taillight and license plate

PART #	DESCRIPTION	SUG. RETAIL
<b>1401-0328</b>	For 82-03 XL	<b>\$89.95</b>



**REAR FENDER**

- Raw steel finish
- Pre-drilled for OEM fender struts, license plate mounts and taillight

PART #	DESCRIPTION	SUG. RETAIL
<b>1401-0327</b>	For 82-94 FXR (except FXRT); repl. OEM #59634-81A	<b>\$109.95</b>

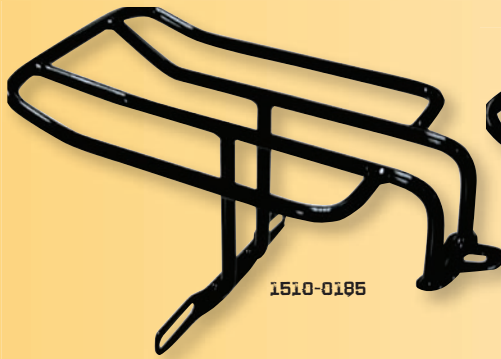

1510-0185

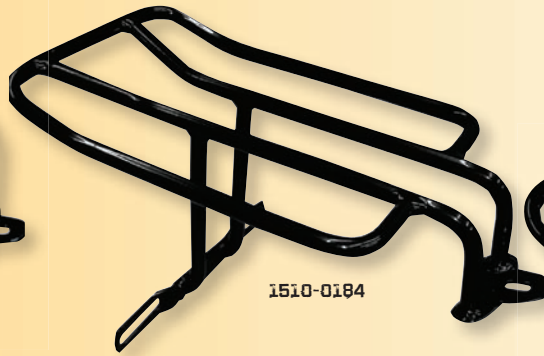

1510-0184

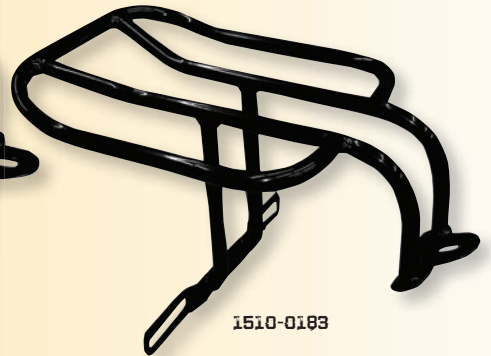

1510-0183

**BLACK FENDER LUGGAGE RACKS**

- Racks are made of 3/8" steel tubing; carries up to 10 lb.
- Gloss black powdercoat finish
- Mounts to stock seat mounting screw and license plate bracket
- Mounting hardware and instructions included

PART #	DESCRIPTION	SUG. RETAIL
<b>1510-0185</b>	For 06-12 FXD w/ conventional license plate mount	<b>\$59.95</b>
<b>1510-0184</b>	For 91-05 Dyna Glide (except FXDWG) (10" L x 6" W)	<b>\$59.95</b>

PART #	DESCRIPTION	SUG. RETAIL
<b>1510-0183</b>	For 94-12 XL (except 883N/1200N/1200X) (8 1/2" L x 6" W)	<b>\$59.95</b>

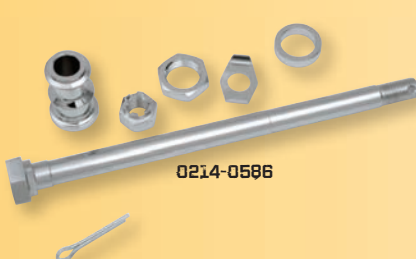

0214-0566



0214-0578



0214-0580



0214-0581

**CHROME AXLE KITS**

- Bright chrome finish on axle and hardware beautifies your bike
- Machined from chromoly steel
- Kits include axle, spacers, nuts and washers

NOTE: Rear axle length given is measured from the inside of the bolt head to the end of the threads.

PART #	DESCRIPTION	SUG. RETAIL
<b>0214-0586</b>	For 48-57 FL	<b>\$59.95</b>
<b>0214-0578</b>	For 36-47 Knucklehead (10.625")	<b>\$59.95</b>

PART #	DESCRIPTION	SUG. RETAIL
<b>0214-0580</b>	For 62-72 Big Twin (11.1875")	<b>\$52.95</b>
<b>0214-0581</b>	For 73-84 Big Twin	<b>\$49.95</b>



## SLIDER BUSHINGS

- High-quality replacement bushings
- Sold in pairs

PART #	DESCRIPTION	SUG. RETAIL
<b>FOR 49-65 PANHEAD, 66-77 SHOVELHEAD</b>		
<b>0403-0043</b>	Upper bushings; repl. OEM #45824-49	<b>\$13.95</b>



0403-0043



0403-0044

PART #	DESCRIPTION	SUG. RETAIL
<b>FOR 49-65 PANHEAD, 66-77 SHOVELHEAD (CONT)</b>		
<b>0403-0044</b>	Lower bushings; repl. OEM #45823-49	<b>\$15.95</b>



0710-0137



## OIL TANKS

- Replacement OEM-style oil tank for swingarm frames
- Available with chrome or raw finish
- Include dipstick and drain plug
- Accept OEM mounting hardware and oil lines
- Approximately 3 quart capacity

PART #	DESCRIPTION	SUG. RETAIL
<b>FOR 58-64 PANHEAD</b>		
<b>0710-0137</b>	Chrome	<b>\$179.95</b>
<b>0710-0138</b>	Raw; Repl. OEM #62504-58	<b>164.95</b>



## CHROME TRANSMISSION SIDE COVER

- Made from chrome-plated, die-cast zinc
- Mounts with existing hardware

PART #	DESCRIPTION	SUG. RETAIL
<b>1105-0035</b>	For 07-12 FLT/FLHT/FLHR/FLTR/H-D FL Trike; 06-12 FXD, FXDWG; 07-12 FXST/FLST; repl. OEM #37116-06	<b>\$54.95</b>



## OIL TANKS FOR RIGID FRAMES

- Replacement OEM-style horseshoe oil tank for rigid frame models
- Available in chrome or raw finish
- Includes dipstick and drain plug
- Accepts OEM mounting hardware and oil lines
- Approximately 3 quart capacity

PART #	DESCRIPTION	SUG. RETAIL
<b>FOR 36-47 PANHEAD</b>		
<b>0710-0127</b>	Chrome	<b>\$179.95</b>
<b>0710-0136</b>	Raw; repl. OEM #62504-38	<b>164.95</b>



0710-0127



## TRAILER WIRING KIT WITH BRACKET

- Includes chrome-plated, bolt-on bracket, sleeved five-wire harness, male/female five-pin wiring plug connectors
- Provides bolt-on wiring connection with Khrome Werks trailer hitches on 1980-1996 Touring models

PART #	DESCRIPTION	SUG. RETAIL
<b>3902-0110</b>	For 80-96 FLT/FLHT/FLHR/FLSTC	<b>\$49.95</b>

## TODD'S CYCLE

Your customers are now seeing Todd Silicato as well as his Todd's Cycle custom bikes and parts in all the big magazines, TV shows and of course rallies. With innovative new products constantly being developed Todd's line-up has something for just about every ride and rider. The new 1 1/4" handlebars are available in several different finishes and bends to suit any ride. Be sure to have some on hand for your customers.



### 1 1/4" CLUB HANDLEBARS

- Handlebars mount using stock hardware
- Slotted for internal wiring
- Made in the U.S.A.

PART #	DESCRIPTION	END RISE	WIDTH	CENTER WIDTH	PULLBACK	SUG. RETAIL
<b>FOR 11-12 FXS WITH OEM TOP TREE</b>						
0601-1875	Chrome	8.5"	28"	5.5"	3.5"	<b>\$285.95</b>
0601-1881	Gloss black	8.5"	28"	5.5"	3.5"	<b>285.95</b>
0601-1882	Flat black	8.5"	28"	5.5"	3.5"	<b>285.95</b>

### 1 1/4" STRIP HANDLEBARS

- Feature polished welds
- Slotted for internal wiring
- Offer a clean line of sight to the stock mirrors
- Made in the U.S.A.

PART #	DESCRIPTION	END RISE	WIDTH	CENTER WIDTH	PULLBACK	SUG. RETAIL
<b>FOR 11-12 FXS WITH OEM TOP TREE</b>						
0601-1871	Chrome	12"	29"	5.5"	4"	<b>\$285.95</b>
0601-1872	Gloss black	12"	29"	5.5"	4"	<b>285.95</b>
0601-1873	Flat black	12"	29"	5.5"	4"	<b>285.95</b>



### INFORMER LED FUEL/BATTERY GAUGE

- Cap incorporates LED battery and LED fuel gauge
- Daylight sensor adjusts LED brightness level
- Fuel gauge illuminates a single green LED when full, from full to 5/8 tank a string of green LEDs, from 1/2 to 1/4 tank amber LEDs, from 1/4 red LEDs, and when near empty a flashing single red LED
- "Empty" fuel level at which the red LED begins flashing can be set by the rider
- Battery gauge shows green LEDs when the charging system is between 12.5V and 14.5V, amber LEDs if the bike is not charging and flashing red LEDs if charging level exceeds 15V or drops below 10V
- Gauge works in all models with fuel gauge mounted in the left fuel tank (except 08-12 FXST/FLST and FLHR)
- The perfect match for Kuryakyn's flush-mount gas cap

PART #	DESCRIPTION	SUG. RETAIL
2212-0368	Informer LED battery/fuel gauge	<b>\$129.95</b>



### SPEEDOMETER AND TACHOMETER GAUGE BROW

- Thin contour gauge brow adds a sleek accent but doesn't restrict being able to see the gauges at a glance
- Chrome-plated ABS construction
- Peel-and-stick installation
- Sold each

PART #	DESCRIPTION	SUG. RETAIL
2211-0110	For 96-12 FLHT/FLHX and H-D FL Trikes	<b>\$23.95</b>

