

INSTALLATION INSTRUCTIONS

DRAG SPECIALTIES GAS TANK P/N DS-391273, DS-390076

CAUTION: Gas tanks MUST be properly installed, sealed and pressure tested BEFORE painting.

ATTENTION INSTALLER: (if other than owner): Please forward this instruction sheet to the purchaser of this product. These instructions contain valuable information necessary to the end user.

INTRODUCTION: These instructions describe the procedure for properly installing rubber-mounted Quickbob® gas tanks on most Harley-Davidson® Sportster models.

Review instructions carefully before beginning, as they contain important information. Please retain for future reference.

Particularly important information is distinguished in these instructions by the following notations:

NOTE: A NOTE provides key information to make procedures easier or clearer.

CAUTION: A CAUTION indicates special procedures that must be followed to avoid damage to the motorcycle and/or accessories.

WARNING: A WARNING indicates special procedures that must be followed to avoid injury to a motorcycle operator or person inspecting or repairing the motorcycle.



TOOLS REQUIRED:

- 1 - 7/16" combination wrench
- 1 - 1/2" combination wrench
- 1 - 9/16" combination wrench
- 1 - large adjustable wrench
- 1 - 1/8" hex key
- 1 - 1/4" hex key
- 1 - flat-blade screwdriver

CAUTION: Tank should be mounted, then removed, cleaned and sealed on the inside before painting to help prevent leaks. Also when mounting tank, do not stress any of the mounting tabs when tightening down the tank, as this can cause cracking. Use flat washers for shims if necessary.

NOTE: Use Big Twin speedometer with a ratio of 2:1 for 82-90 models and speedometer with a ratio of 2240:60 for 91-94 models. 95-02 models will require DS-391284 coil/ignition relocation kit/speedometer housing for the proper mounting of ignition switch and stock electronic speedometer. Please follow instructions furnished with DS-391284 kit.

DRAG SPECIALTIES

Box 9336, Minneapolis, MN 55440

INSTALLATION INSTRUCTIONS

DRAG SPECIALTIES GAS TANK P/N DS-391273, DS-390076

CAUTION: Installing this kit on your motorcycle will require modifications to your wiring harness. We strongly suggest that you have a wiring schematic for your motorcycle. Because of the wide range of years this kit will work on, your motorcycle wiring may be slightly different than what is shown in the instructions. If you are not comfortable working with wiring, soldering, etc., we suggest you have a qualified technician do the installation work. Make sure you disconnect the battery before attempting any modifications. In any case make sure you do the wiring work before you have the gas tank painted. If you paint the tank and then try to make the following modifications damage to the newly painted surfaces will probably result. We highly recommend that you solder and use heat shrink tubing to isolate any wiring connections made to prevent short circuits. Be sure you are using the correct wires. We will not be responsible for any type of damage resulting from any wiring modifications of any type. Check and double check your wiring. Make sure the circuit breakers and fuses are not disabled. You can burn up the entire wiring harness in your motorcycle in seconds if not wired correctly. If you are not sure, find someone who is.

PROCEDURE:

Begin by placing the motorcycle on its side stand.

1. Drain fuel from existing gas tank into an approved container. Make sure you are in a well ventilated area away from any flame or sparks. Remove the existing gas tank and retain the OEM petcock.
2. Mount front bracket (6) on to frame using bolt (7), star washers (8) and nut (9). Pass the bolt through unthreaded hole closest to the front of the bracket, then through the front frame mounting hole.
3. On 883 models only, attach horn bracket (15) to front bracket (6) using bolt (14), star washers (8) and nuts (9).
4. Attach OEM coil and coil bracket using button head screws (13), star washers (8) and nuts (9). Coil bracket attaches to holes on front bracket that are farthest back.
5. Install rubber grommets (3) into holes in front of fuel tank, then push inserts (4) into grommets.
6. Push shoulder inserts (10) into rubber shoulder spacers (11).
7. Pass double-threaded bolt (12) through rear tank mounting hole in frame tube, then assemble rubber shoulder spacers/inserts and washers (2) on to bolt. Tighten securely.
8. Attach petcock to tank using thread sealer and adapter (5) if necessary.
9. Carefully slide tank on to rear mount until front grommets align with threaded holes in front mount. Install assembly using bolts (1) and washers (2). Tighten securely.
10. Install dash base, speedometer and dash cover using spacers (16) if necessary.

WARNING! Check all mounts and fuel line fittings before filling with fuel. Double check all fuel lines and fittings for leaks. Check all electrical wiring to be sure it is not binding or pinched. Test ride motorcycle and recheck all fuel lines and fittings for leaks.

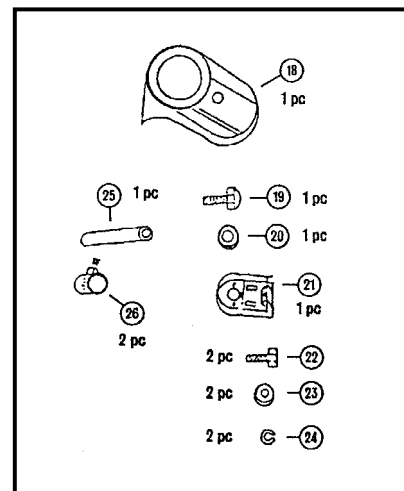
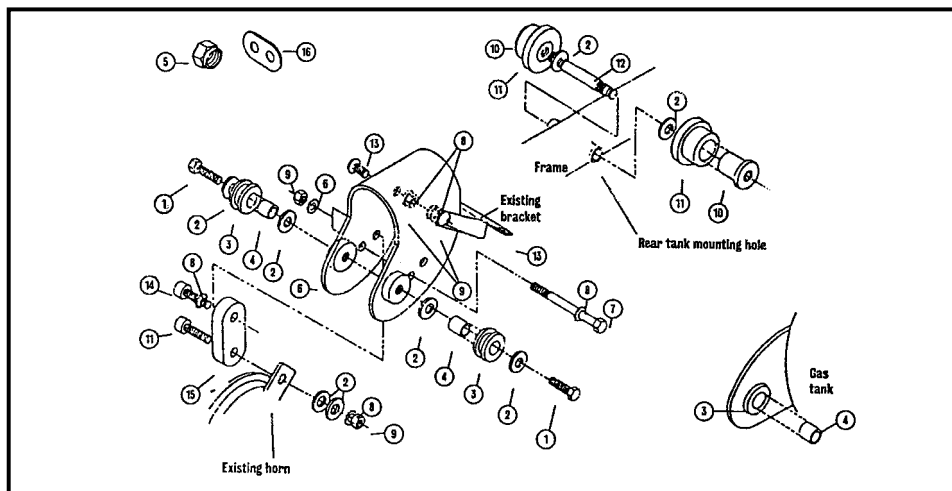

DRAG SPECIALTIES

Box 9336, Minneapolis, MN 55440