



Front Bumper Mounting Instructions

2009-11 Polaris Sportsman XP 550/850

Part Number: 2915 (0530-1265)

Ref.	Qty.	Part#	Description
1	1	2913-1	Front Bumper
2	1	2913-16	Mount Bracket - 2009
3	2	HDW9068	1/4"-20 x 7" Hex Bolts
4	2	HDW2050	5/16" x 3/4" Hex Bolts
5	2	HDW7058	5/16" Nylock Nuts
6	2	HDW9002	5/16" Flat Washer
7	8	HDW9012	1/4" Flat Washer
8	2	HDW7050	1/4" Nylock Nut
9	4	HDW9064	1 5/8" Endcaps
10	4	HDW1084	6mm x 30mm Hex Bolts
11	4	HDW1120	6mm Nylock Nuts
12	1	2915-1	Mount Bracket - 2010-11

INSTRUCTIONS FOR 2009 MODELS (You will NOT use part #2915-1):

1. In order to install the brushguard mount bracket (#2) you will need to remove all the front plastic and steel lower pan. You will just need to remove 6 bolts, two plastic pins on the outside of the headlights, and unplug the headlights.
2. The mount bracket will bolt through the two inner holes in the radiator mount. Use two 5/16" x 3/4" hex bolts (#4) from the inside pointing out. Bolt the bracket in place with the tabs facing up using two 5/16" flat washers (#6) and 5/16" nylock nuts (#5). See photos.
3. Reinstall the top portion of the front plastic that contains the headlights. Place the silver steel lower pan in place in the bottom of the brushguard and put both in place on the machine (otherwise you wont be able to fit it in place later). The two small center tubes of the brushguard will go though the triangular holes in the plastic and match up to the bracket you mounted in step #2.
4. Slide the bottom of the brushguard and steel bumper pan into place on either side of the lower frame mounts and loosely bolt into place using the factory bolts removed earlier.
5. Now loosely bolt the upper brushguard mounts in place through the bracket you mounted earlier using two 1/4" x 7" bolts (#3), four 1/4" flat washers (#7), and two 1/4" nylock nuts (#8).
6. Make sure the bumper is aligned properly with the front of the machine and tighten all nuts and bolts.

NOTE: This bumper is designed to be used as a brushguard only and should not be used to push heavy objects. Bent or damaged bumpers will not be warranted.

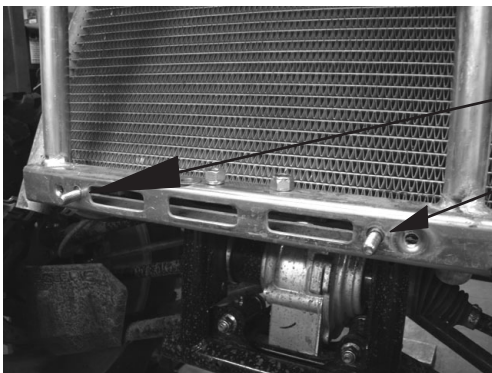

Install bolts from the inside out through these holes in the radiator mount.

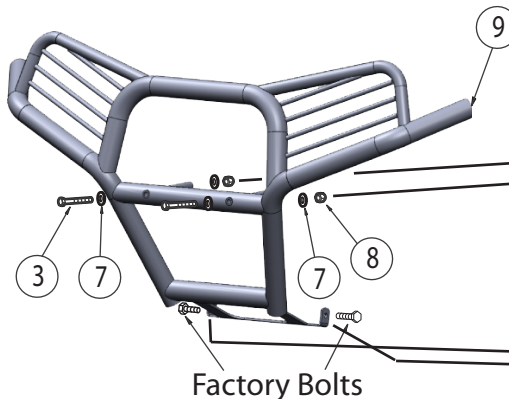
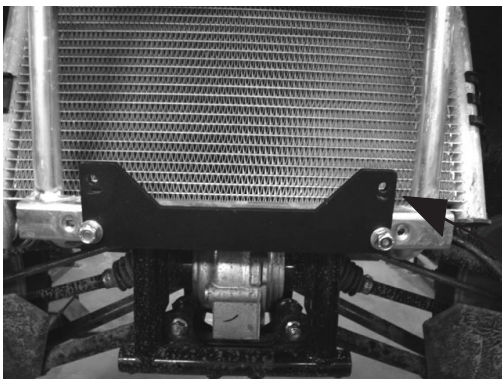

Install the mount bracket with the tabs facing up.



FOR QUESTIONS OR COMMENTS PLEASE CALL: **763-689-4800**

Front Bumper



Mounting Instructions

2009-11 Polaris Sportsman XP 550/850
Part Number: 2915 (0530-1265)

INSTRUCTIONS FOR 2010-11 MODELS (You will NOT use bracket 2913-16):

1. In order to install the brushguard mount bracket (#12) you will need to remove all the front plastic and lower pan. You will need to remove 6 bolts, two plastic pins on the outside of the headlights, and unplug the headlights.
2. The mount bracket will bolt to the two aluminum vertical brackets in front of the radiator. First drill out the existing holes in the brackets using a 1/4" drill bit.
3. Bolt the bracket in place per the illustration using two 6mm x 30mm hex bolts (#10), 1/4 flat washers (#7), and 6mm nuts (#11).
4. Reinstall the top portion of the front plastic that contains the headlights. Place the lower pan in place in the bottom of the brushguard and put both in place on the machine (otherwise you may not be able to fit it in place later). The two small center tubes of the brushguard will go through the triangular holes in the plastic and match up to the bracket you mounted in step #3.
5. Now loosely bolt the upper brushguard mounts in place through the bracket you mounted earlier using two 1/4" x 7" bolts (#3), four 1/4" flat washers (#7), and two 1/4" nylock nuts (#8).
6. Slide the bottom of the brushguard and lower bumper pan into place on either side of the lower frame mounts and loosely bolt into place using the factory bolts removed earlier.
7. Make sure the bumper is aligned properly with the front of the machine and tighten all nuts and bolts.

NOTE: This bumper is designed to be used as a brushguard only and should not be used to push heavy objects. Bent or damaged bumpers will not be warranted.

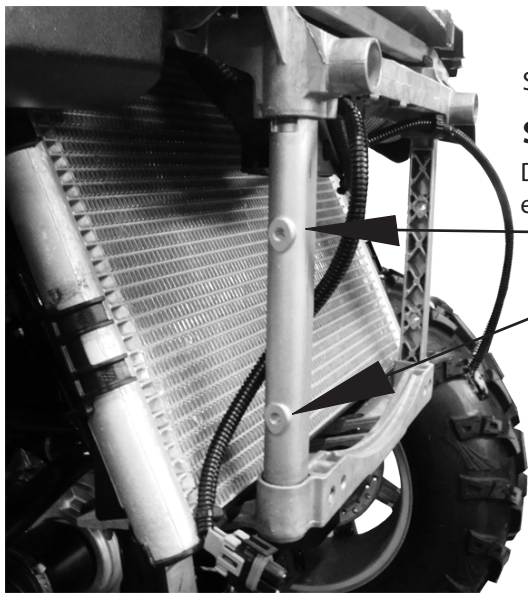

Shown with front end removed.

Step 1

Drill out these two holes on each side with a 1/4" drill bit.

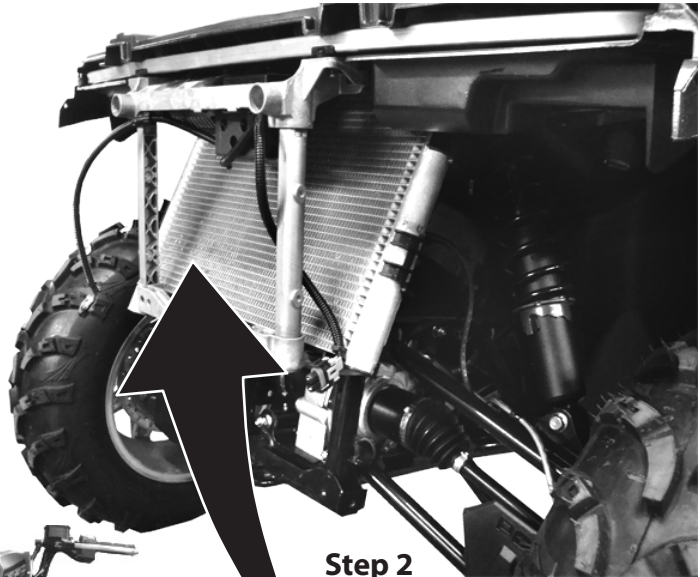

Step 2

Bolt the bracket to the front of the aluminum braces.

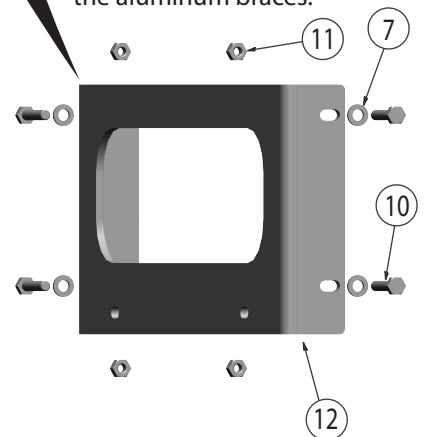

Step 3 Bolt the bumper in place.

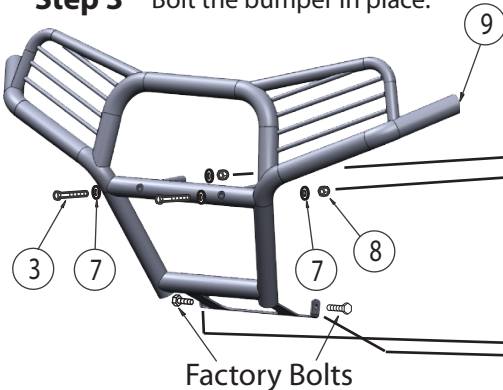

Factory Bolts



FOR QUESTIONS OR COMMENTS PLEASE CALL: 763-689-4800