



Qty.	Part #	Description
1	1612-1	Winch Mount Plate
1	1612-2	Roller Fairlead Plate
2	HDW2050	5/16" x 3/4" Hex Bolts
4	HDW2051	5/16" x 1" Hex Bolts
6	HDW7058	5/16" Nylock Nuts
8	HDW9002	5/16" Flat Washers

**NOTE: Roller fairlead not included with this kit!**

## Winch Mount Installation Instructions

2010-14 Arctic Cat Prowler 550/700/1000

Part Number: 4505-0465

### INSTRUCTIONS:

1. Remove front plastic bumper cover.
2. Bolt the main winch mount plate to the **INSIDE** of the metal frame assembly as pictured. Secure with four 5/16" x 1" hex bolts, eight 5/16" flat washers, and four 5/16" nylock nuts.
3. Orientate your winch so the cable pulls off the bottom of the drum and place it on the main winch mount. Bolt the winch in place using the hardware that came with your winch.
4. Bolt your roller fairlead to the roller fairlead plate. You can leave the plastic bumper cover off permanently or mount the roller fairlead plate over the top of it. If you place the fairlead plate over the top of the bumper cover you will need to cut out the center cover for the winch cable and roller fairlead. Reinstall the plastic bumper cover and/or roller fairlead plate using the factory bolts. **NOTE: The fairlead plate will accept both standard and wide roller fairleads, you will only use the set of holes that line up with your fairlead.**

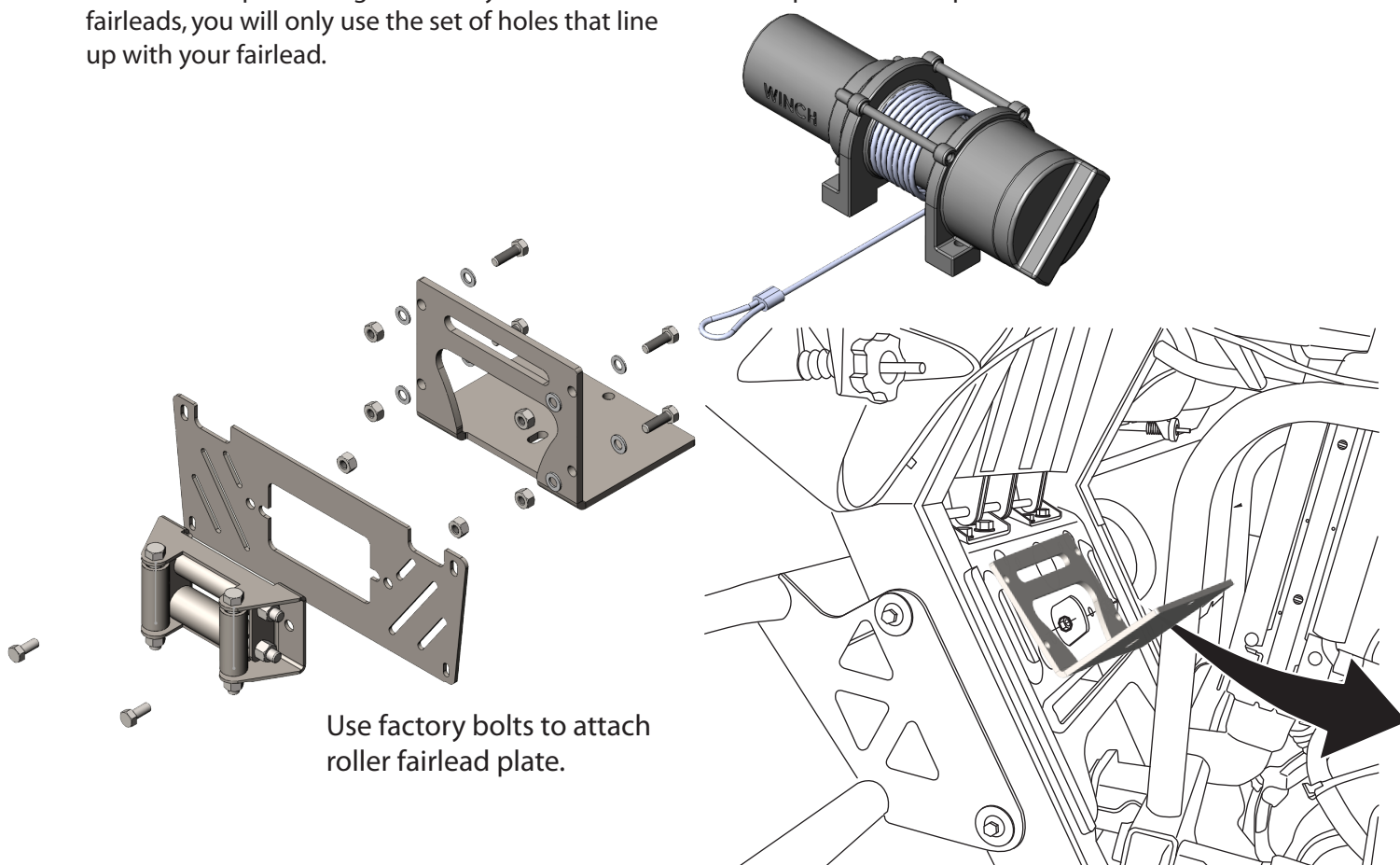

Use factory bolts to attach roller fairlead plate.

**BEHIND BUMPER VIEW**

FOR QUESTIONS REGARDING YOUR ORDER OR RETURNS CONTACT THE COMPANY YOU PURCHASED FROM.

FOR TECHNICAL OR INSTALLATION QUESTIONS PLEASE CALL THE MANUFACTURER: **763-689-4800**

All images used are copyrighted property of CMP and may not be used without permission.

Inst1612M 10/18/2011