



RM4 Plow Mount

Installation Instructions

2007-11 Honda Rancher 420 (All)
Part #: 4501-0330

Ref.	Qty.	Part#	Description
1	1	2588-100	Mount Plate
2	1	2597-200	Removable Mount
3	2	HDW7078	1/2" Nut
4	2	HDW9110	1/2" x 2" Hex Bolt
5	1	HDW9185	Locking Pin
6	2	HDW1056	8mm x 40mm Hex Bolt
7	2	HDW1041	8mm Nylock Nut
8	2	HDW9029	3/8" USS Flat Washer
9	2	HDW2100	3/8" x 1" Hex Bolt
10	2	HDW7061	3/8" Nylock Nut
11	2	HDW2002	1/4" x 1" Hex Bolt
12	2	HDW9012	1/4" Flat Washer
13	2	HDW7050	1/4" Nylock Nut
14	1	1518-4	Spacer Plate

The RM4 Mount kit is designed to allow for quick removal when not needed for plowing. This mount design uses the machines front bumper and frame member to push against and distribute the load when plowing. See below for installation instructions of the mount kit.

NOTE: This RM4 mount will fit with both the Moose winch mount kit and the Honda winch mount kit. If you are experiencing difficulties installing with another brand of winch mount we recommend purchasing a Moose winch mount kit.

INSTALLATION:

1. Remove the front plastic bumper cover and lower plastic skidplate. Remove the bolts that secure the bottom of the front bumper to the frame. **If you already have a winch installed:** You will need to unbolt the winch mount (but keep in place) to ease the installation of the RM4 mount. You may also need to loosen the front bumper to ease installation.
2. The RM4 permanent mount will slide into place from the bottom of the machine per the Illustration. Bolt the two side tabs of the permanent mount to the inside of the frame/front bumper mounts using two 8mm x 40mm hex bolts (#6). Loosely secure with two 8mm nylock nuts (#7). Do not tighten yet. If your winch is already in place, these can be hard to reach. Use a long extension, universal joint, and a short 1/2" socket. You can then get to the nut from the opposite side of the machine.
3. Bolt the rear flange of the mount to the inside of the rear frame member through the large existing holes using two 3/8" x 1" hex bolts (#9), 3/8" USS washers (#8), and 3/8" nylock nuts (#10). Do not tighten yet
4. The next step is to bolt the tall front flange to the front of the horizontal front bumper support plate. **NOTE:** Some winch mounts also use these holes for mounting so you will need to remove any existing bolts. Place the bumper spacer bracket inside the front bumper channel. **NOTE: If you have a Moose winch mount kit, you already have this spacer plate. Only use 1 spacer plate.** Slide the 1/4" x 1" hex bolts (#11) in place from the inside through the spacer bracket, bumper bracket and RM4 mount. Secure with two 1/4" washers (#12) and 1/4" nuts (#13) on the outside of the RM4 mount bracket.
5. Reinstall your winch mount if previously unbolted and then tighten all bolts.
6. You will need to trim the lower plastic skidplate for clearance with the RM4. Hold the skidplate in place and mark the area that will need to be trimmed out for the mount and receiver to fit. Use a sharp knife, hacksaw, or other cutting tool to cut out the skidplate. Put skidplate back in place. Reinstall the front plastic bumper cover.
7. Install the 1/2" bolts (#4) and 1/2" nuts (#3) into the front of the removeable mount. These are used as droop stops to keep the plow from dropping down too far. Thread them in about half way for now. Slide the removeable mount into place on the machine mount and pin from the bottom with the locking pin (#5). You can now attach your push tube and plow assembly.

8. Once the complete plow assembly has been installed on the machine, put the blade straight and on the ground. Adjust both droop stop bolts so there is 1/4" to 1/2" clearance between the bolt heads and the bottom of the push tube. Tighten the lock nuts. **NOTE: Failure to properly adjust the droop stop bolts can put excessive load on the mount, the machine, and winch. This may cause damage and will not be warranted.**

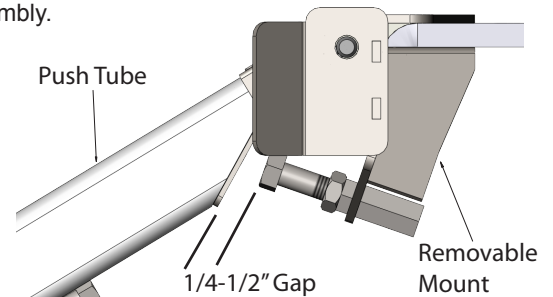

WARNING!

THIS MOUNT KIT IS DESIGNED TO WITHSTAND NORMAL PLOWING FORCES AT A MAXIMUM SPEED OF 5 MPH. EXCESSIVE PLOWING SPEED OR IMPACTING IMMOVABLE OBJECTS MAY DAMAGE THE PLOW, MACHINE, OR OPERATOR AND WILL NOT BE WARRANTED. THIS PLOW SYSTEM IS COVERED BY A ONE YEAR WARRANTY FROM DEFECTS IN MANUFACTURING. PLEASE CONTACT THE MANUFACTURER AT THE NUMBER LISTED BELOW FOR ANY POSSIBLE WARRANTY CLAIMS. BENT OR BROKEN COMPONENTS FROM ABUSE OR EXCESSIVE SPEED WILL NOT BE WARRANTED.

FOR QUESTIONS OR COMMENTS PLEASE CALL THE MANUFACTURER: **763-689-4800**

All images used are copyrighted property of CMP and may not be used without permission.

Inst2588 03/14/2011



RM4 Plow Mount Installation Instructions

2007-11 Honda Rancher 420 (All)

Part #: 4501-0330

Page 2

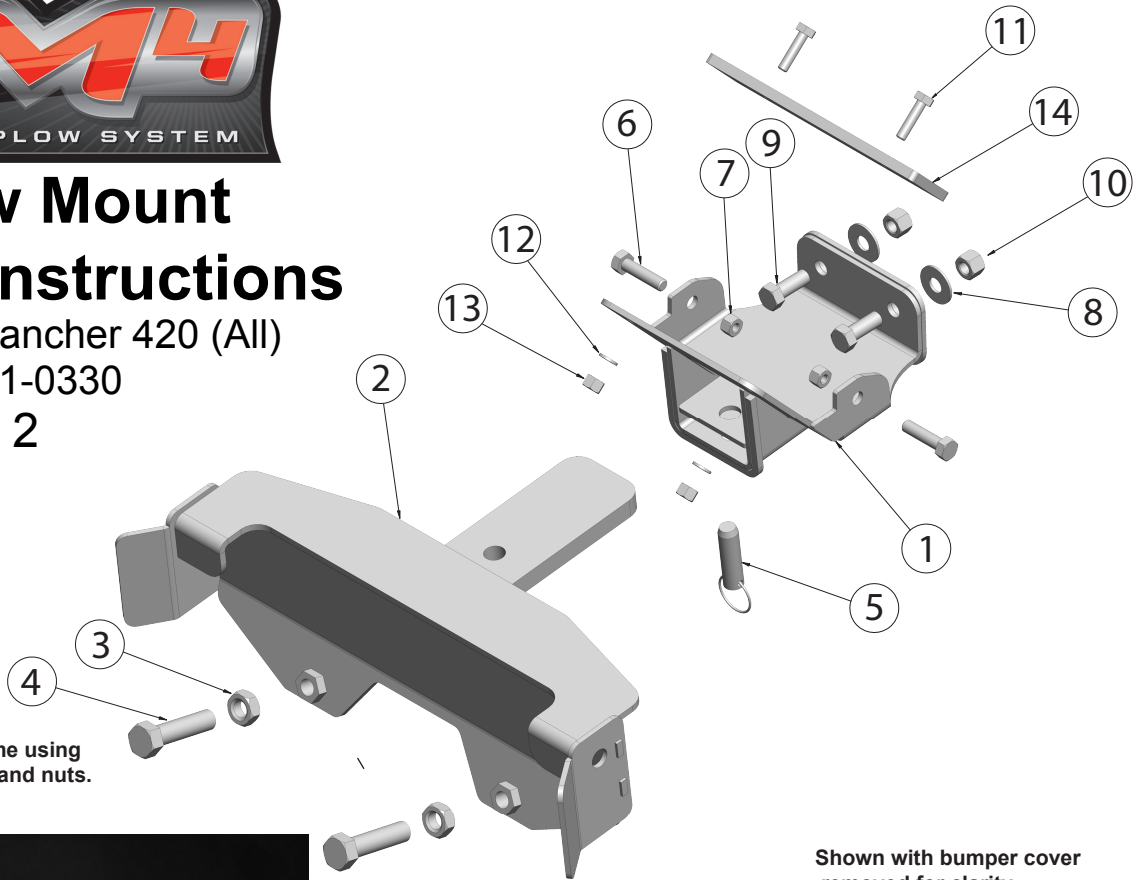

Bolt the back of the mount to the frame using two 3/8" x 1" hex bolts, flat washers, and nuts.

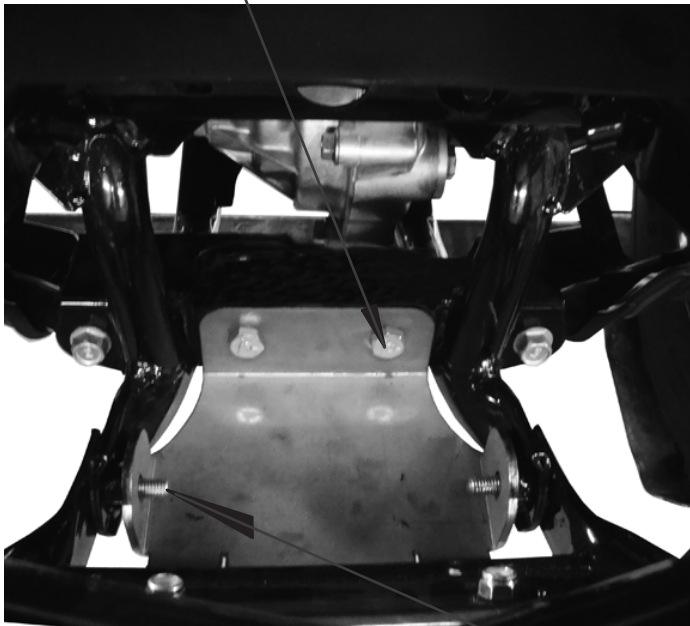

View from inside the front bumper with winch removed.

Shown with bumper cover removed for clarity.



Bolt the mount tabs to the inside of the lower frame/bumper mounts using two 8mm x 40mm hex bolts and nuts.



Cut out the center section for the RM4.

Front bumper cover AFTER cutting.

FOR QUESTIONS OR COMMENTS PLEASE CALL THE MANUFACTURER: **763-689-4800**

All images used are copyrighted property of CMP and may not be used without permission.

Inst2588 03/11/2011