



Ref.	Qty.	Part#	Description
1	1	1508-1	Main Winch Mount Plate
2	1	1508-2	Support Plate
3	4	HDW2100	3/8" x 1" Hex Bolt
4	4	HDW7061	3/8" Nylock Nuts
5	6	HDW9029	3/8" Flat Washers
6	4	HDW9002	5/16" Flat Washers
7	2	HDW2050	5/16" x 3/4" Hex Bolts
8	4	HDW7058	5/16" Nylock Nuts
9	2	HDW2051	5/16" x 1" Hex Bolts

Winch Mount Installation Instructions

for '09 Kawasaki 4010 Mule

INSTRUCTIONS:

Part Number: 1508M (4505-0398)

1. Remove the front plastic bumper cover.
2. Using two 3/8" x 1" Hex Bolts (#3), two 3/8" Flat Washers (#5), and two 3/8" Nylock Nuts (#4), bolt the smaller front support plate (#2) to the inside of the front frame rail per the illustration.
3. Install the winch to the main winch mount (#1) using the hardware supplied with the winch. Be sure to orientate your winch so the cable comes off the bottom of the spool.
4. Install the winch and mount on top of the rear frame rail and front winch support plate. Bolt the rear of the mount to the frame rail using two 3/8" x 1" Hex Bolts (#3), two 3/8" Flat Washers (#5), and two 3/8" Nylock Nuts (#4). Bolt the front of the mount to the front support plate installed earlier with two 5/16" x 1" Hex Bolts (#9), four 5/16" Flat Washers (#6), and two 5/16" Nylock Nuts (#8).
5. Install your roller fairlead (#9) to the winch mount using two 5/16" x 3/4" Hex Bolts (#7) and 5/16" Nylock Nuts (#8). The larger roller goes on the bottom. (**NOTE:** Bottom roller may need to be removed to run wire rope through.)
6. Using the instructions provided with the winch, wire accordingly.
8. Reinstall the plastic bumper cover. **NOTE:** For some winches, this cover may need to be trimmed so it does not rub.

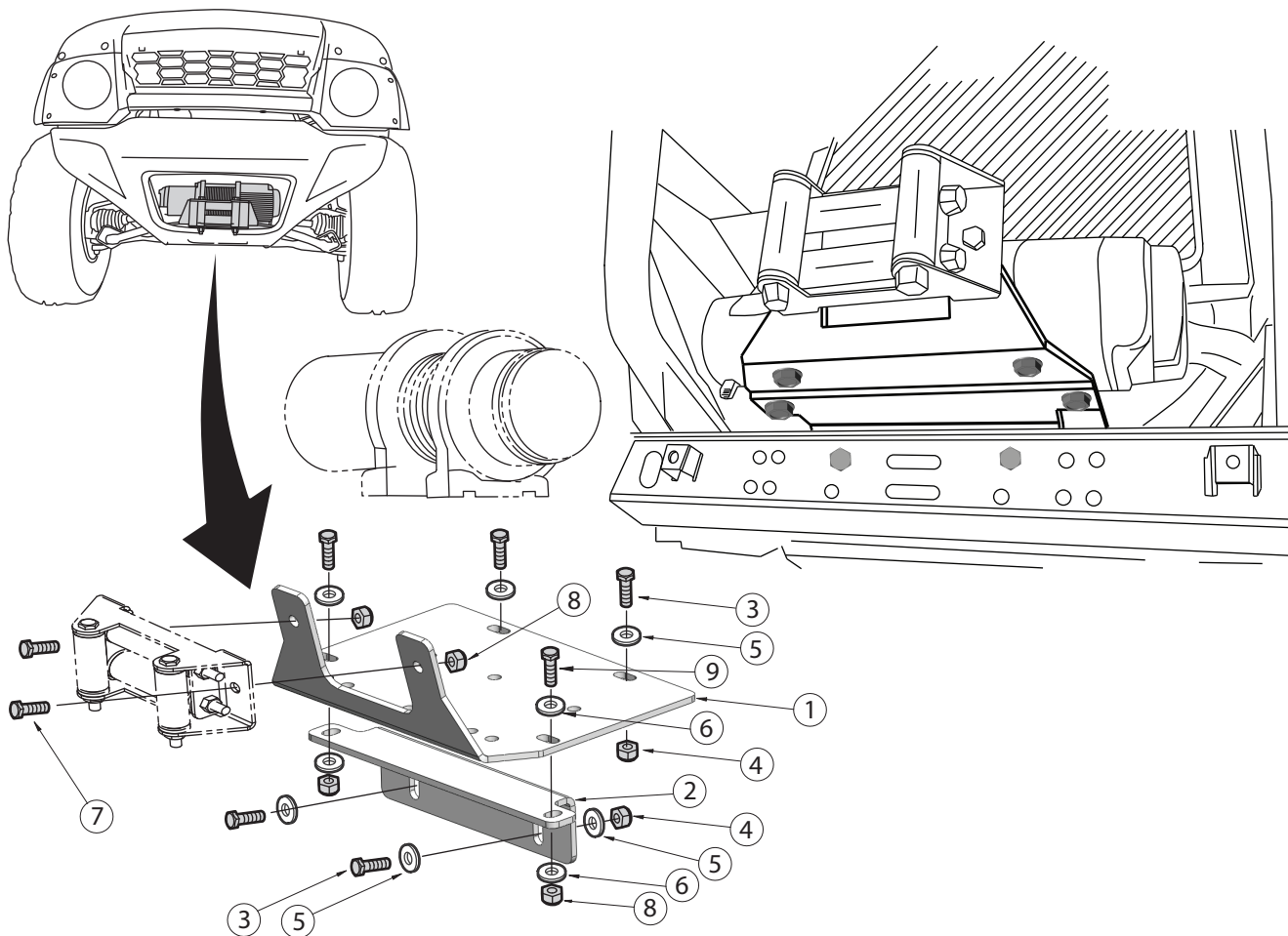

FOR QUESTIONS OR COMMENTS PLEASE CALL THE MANUFACTURER: **763-689-4800**

All images used are copyrighted property of CMP and may not be used without permission.

Inst1508M 09/15/08