

Winch Mount

Kawasaki '05-10 750 Brute Force

Part Number: 1548M (4505-0376)



Item	Qty.	Part#	Description
1	1	1548-1	Winch Mount Plate
2	4	HDW2150	5/16" x 1-1/8" x 1-3/4" U-Bolts
3	8	HDW7058	5/16" Nylock Nuts
4	8	HDW9002	5/16" Flat Washers

1. Remove the upper plastic bumper. Retain hardware.
2. Remove the two bolts that attach the lower plastic bumper for easier access.
3. Attach the Winch Mount Plate (1) using the four U-bolts (2), eight 5/16" Flat Washers (4) and eight 5/16" Nylock Nuts (3) as illustrated.
4. Attach the Roller Fairlead to the winch mount plate using the two 5/16" x 3/4" Hex Head Bolts and two 5/16" Nylock Nuts.
5. Orientate the winch so the cable pulls from the bottom of the drum. Bolt in place using the hardware provided with your winch.
5. Reattach the plastic OEM bumpers using the hardware retained.

NOTE: Roller fairlead not included with this kit!

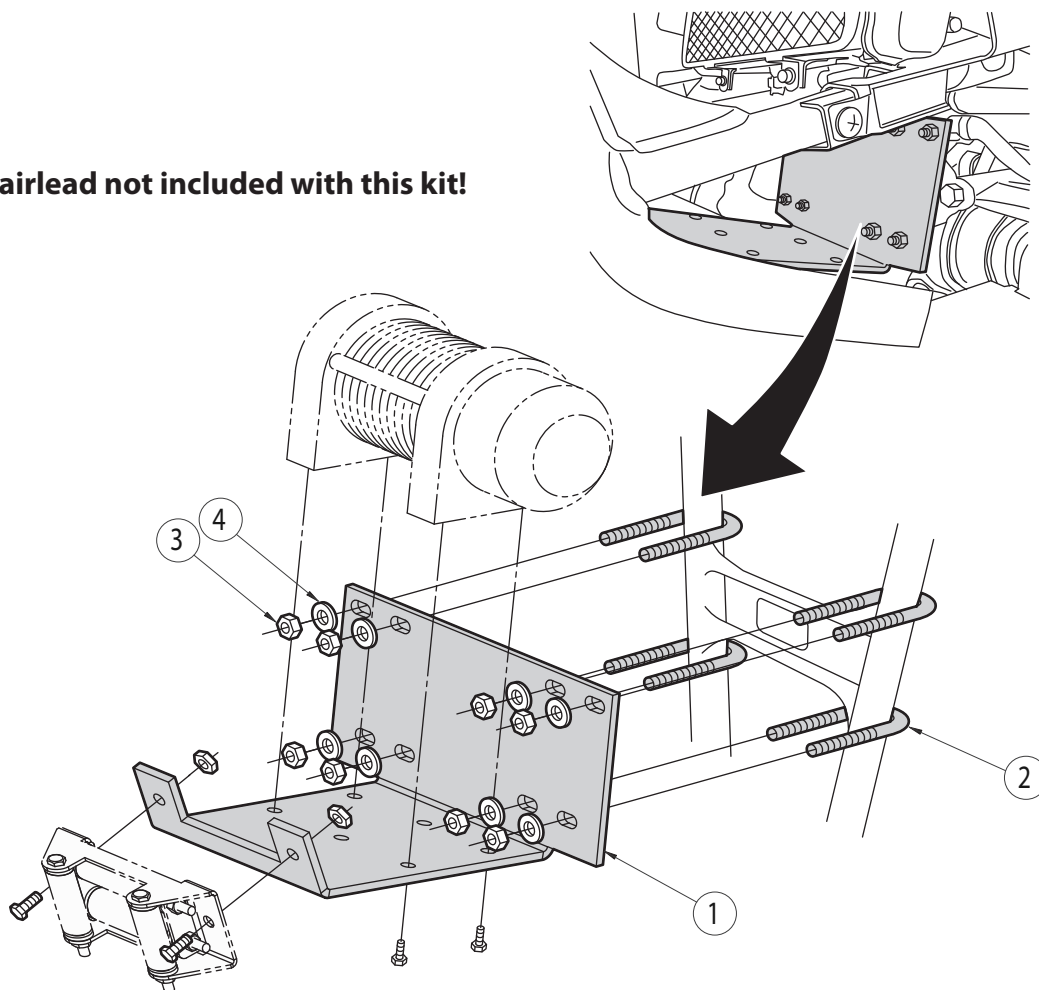

FOR QUESTIONS OR COMMENTS PLEASE CALL THE MANUFACTURER: **763-689-4800**

All images used are copyrighted property of CMP and may not be used without permission.

Inst1548M 07/22/07