



Ref#.	Qty.	Part #	Description
1	1	1613-1	Winch Mount Plate
2	1	1613-2	Roller Fairlead Plate
3	4	HDW7058	5/16 Nylock Nuts
4	2	HDW2050	5/16" X 3/4" Hex Bolts
5	2	HDW2051	5/16" x 1" Hex Bolts
6	2	HDW1069	10mm x 30mm Hex Bolts
7	2	HDW9001	3/8" Flat Washers

Winch Mount Installation Instructions

2009 Honda Big Red

Part Number: 1613M (4505-0406)

INSTRUCTIONS:

1. Remove the one-piece front bumper assembly and retain the hardware.
2. Loosen both bolts holding the front differential mount to the frame. Remove and replace them one at a time with a 10mm x 30mm hex bolt (#6) and flat washer (#7). Leave them loose and slide the mount plate in place under the bolts heads and washers. Do not tighten the bolts yet.
3. Set your winch in place on top of the mount plate but do not bolt in yet. Make sure to orientate your winch so the cable pulls off the bottom of the drum.
4. Bolt the front bumper back in place on the machine.
5. Using two 5/16" x 1" hex bolts (#5) and 5/16" nylock nuts (#3), bolt your roller fairlead and roller fairlead mount plate to the main winch mount plate per the illustration. **Note:** The roller fairlead plate will go on the outside of the stock bumper. The larger roller goes on the bottom. **Note:** Bottom roller may need to be removed to run the wire rope through. If using an aluminum hawse instead of a roller fairlead you may need different hardware, check the hardware that was supplied with your winch.
6. Center the roller fairlead (and entire mount) in the bumper opening and mark the two remaining holes in the bottom of the fairlead plate. Drill though the metal bumper pan with a 3/8" drill bit and bolt into place using two 5/16" x 3/4" hex bolts (#4) and 5/16" nylock nuts (#3).
7. You can now tighten the two back bolts on the main winch mount plate.
8. Using the hardware that came with your winch, bolt the winch to the plate. Using the instructions provided with the winch, wire accordingly.

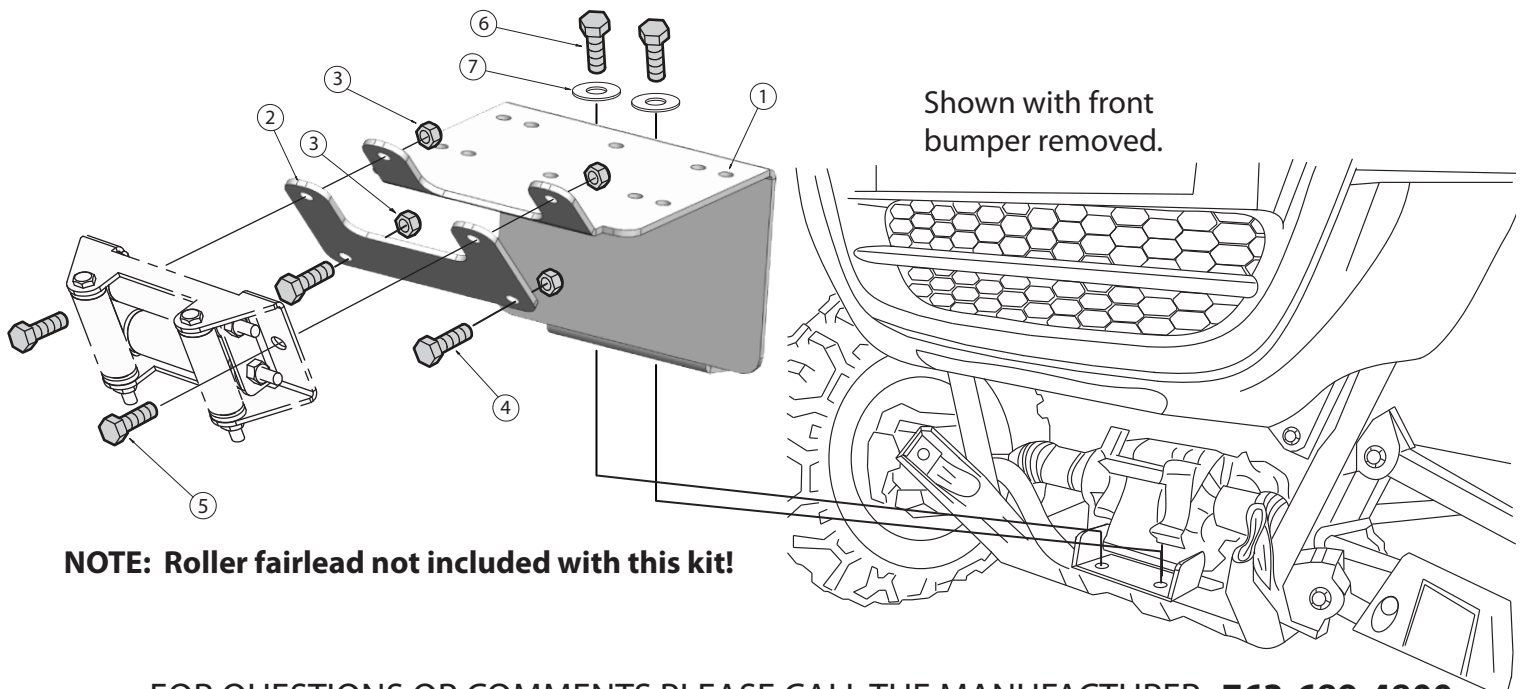

NOTE: Roller fairlead not included with this kit!

FOR QUESTIONS OR COMMENTS PLEASE CALL THE MANUFACTURER: **763-689-4800**

All images used are copyrighted property of CMP and may not be used without permission. Inst1613M 10/15/08