



Qty.	Part #	Description
1	1552-1	Winch Mount
2	HDW2050	5/16" x 3/4" Hex Bolts
4	HDW2051	5/16" x 1" Hex Bolts
6	HDW7058	5/16" Nylock Nuts
8	HDW9002	5/16" Flat Washers

NOTE: Roller fairlead not included with this kit!

Winch Mount Installation Instructions

for '04-'09 Yamaha Rhino 450, 660, 700 4x4

Part Number: 1552M (4505-0402)

1. Remove front of skid pan.
2. Install winch mount onto bumper per illustration using the 4 provided 1" bolts, flat washers, and nuts. It may be necessary to loosen the front bumper to install the front bolts. Re-tighten after installing bolts.
3. Orientate the winch so the cable pulls off the bottom of the drum and bolt in place using the hardware provided with your winch.
4. Attach roller fairlead to front of the mount using the (2) 3/4" bolts and Nylock nuts. (Rollers should turn freely.) **Note:** Bottom roller may need to be removed to run wire rope through.
5. Using instructions provided with the winch, wire accordingly.

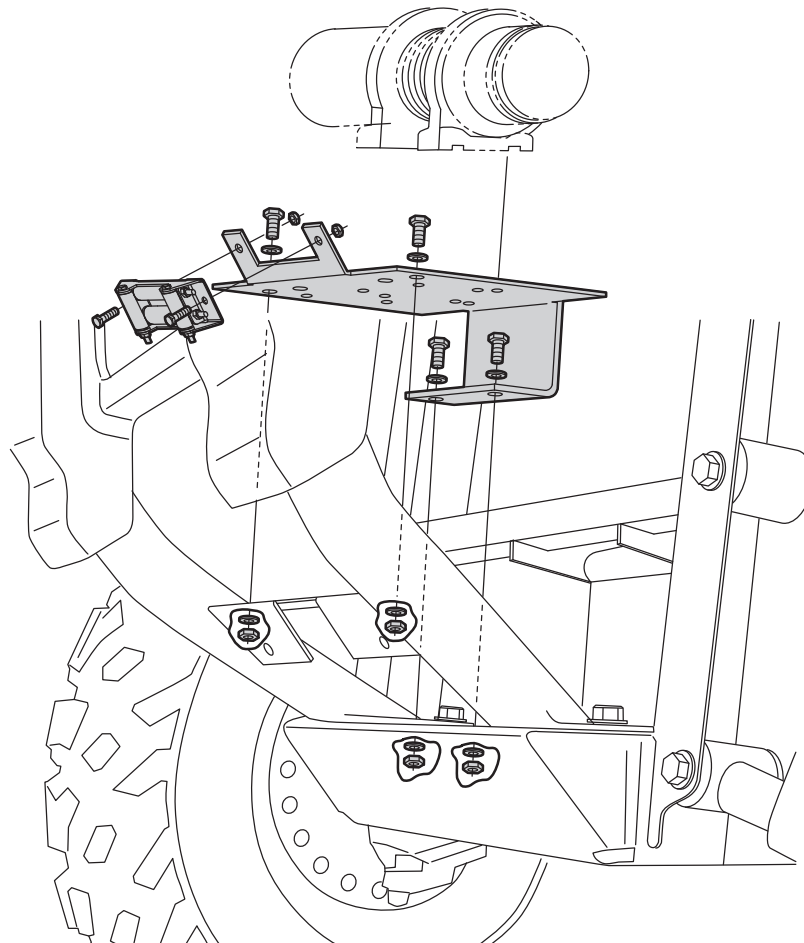

FOR QUESTIONS OR COMMENTS PLEASE CALL THE MANUFACTURER: **763-689-4800**

All images used are copyrighted property of CMP and may not be used without permission.

Inst1552M 01/10/07