



WINCH MOUNT

YAMAHA

'07-09 400 Big Bear

Item	Qty.	Part#	Description
1	1	1568-2	Winch Mount Bottom Plate
2	1	1568-1	Winch Mount Spacer Plate
3	6	HDW2050	5/16" x 3/4" Hex Head Bolts
4	1	HDW2051	5/16" x 1" Hex Head Bolts
5	2	HDW2061	5/16" x 1 1/4" Hex Head Bolts
6	9	HDW7058	5/16" Nylock Nuts
7	5	HDW9002	5/16" Flat Washers

NOTE: Roller fairlead not included with this kit!

PN: 1568M (4505-0382)

INSTRUCTIONS:

1. Remove the existing lower skid plate and retain all hardware.
2. If you have a winch that has a two hole bolt pattern, follow illustration 1. The winch will bolt through the two front holes in the spacer plate and winch mount plate. Use a 5/16" washer under the frontmost slotted hole. Use the 5/16" x 1" bolt through the back hole in the spacer plate and winch mount.
3. If you have a winch that has a four hole bolt pattern, follow illustration 2. Use the bolts that came with your winch up through the bottom of the frame tabs, through the winch plate, and into the winch.
Note: Winches with four bolt hole patterns do not use the Winch Mount Spacer Plate (2) and related hardware.
4. Install your Roller Fairlead (Not Included) using two 5/16" x 3/4" Hex Head Bolts (3) and two 5/16" Nylock Nuts (6).
5. Reinstall the lower skid plate.

Illustration #1
for installing
2-bolt pattern
winches.

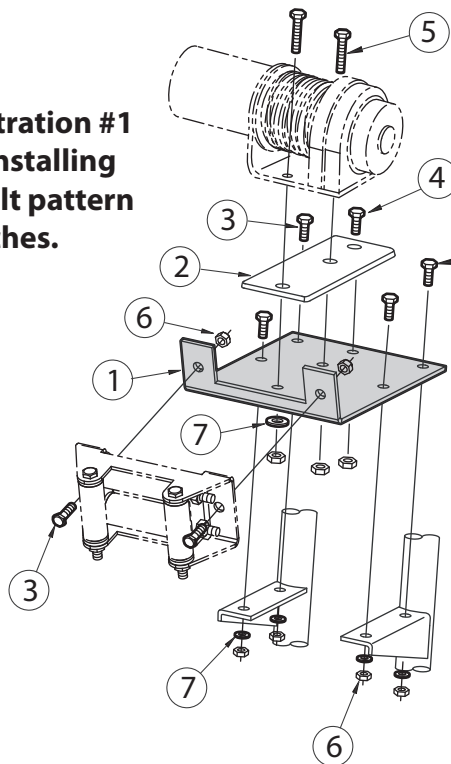
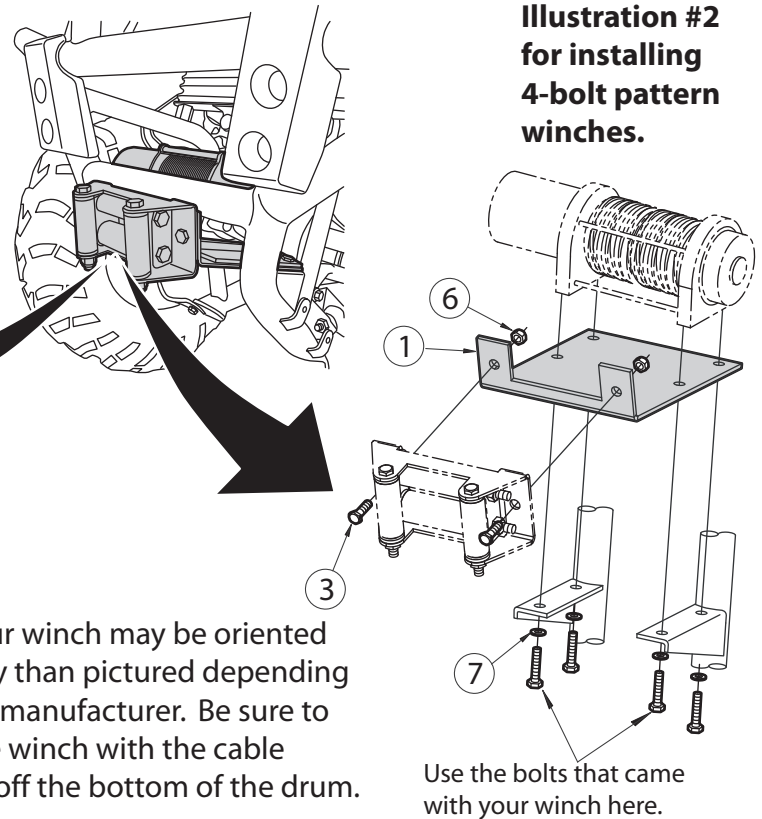

Illustration #2
for installing
4-bolt pattern
winches.



NOTE: Your winch may be oriented differently than pictured depending upon the manufacturer. Be sure to orient the winch with the cable spooling off the bottom of the drum.

Use the bolts that came with your winch here.

FOR QUESTIONS OR COMMENTS PLEASE CALL THE MANUFACTURER: **763-689-4800**

All images used are copyrighted property of CMP and may not be used without permission. Inst1568M 06/29/2009