



Qty.	Part#	Description
1	1554-1	Winch Mount
6	HDW2050	5/16" x 3/4" Hex Bolts
6	HDW7058	5/16" Nylock Nuts
4	HDW9002	5/16" Flat Washers

NOTE: Roller fairlead not included with this kit!

Winch Mount Installation Instructions

Suzuki '05-'09 450/500/700/750 King Quad

Part Number: 1554M (4505-0378)

INSTRUCTIONS:

1. Position the winch mount behind the front bumper, on the inside of the frame tabs, and align the holes in the winch mount with the holes in the frame. Install the (4) provided bolts through the frame tabs, then the winch mount using the flat washers and nylock nuts.
2. Orientate the winch so the cable pulls off the bottom of the drum and bolt in place using the hardware provided with the winch.
3. Install the roller fairlead using (2) 5/16" x 3/4" hex bolts and 5/16" nylock nuts provided (rollers should turn freely). **Note:** Bottom roller may need to be removed to run wire rope through.
4. Using the instructions provided with the winch, wire accordingly.

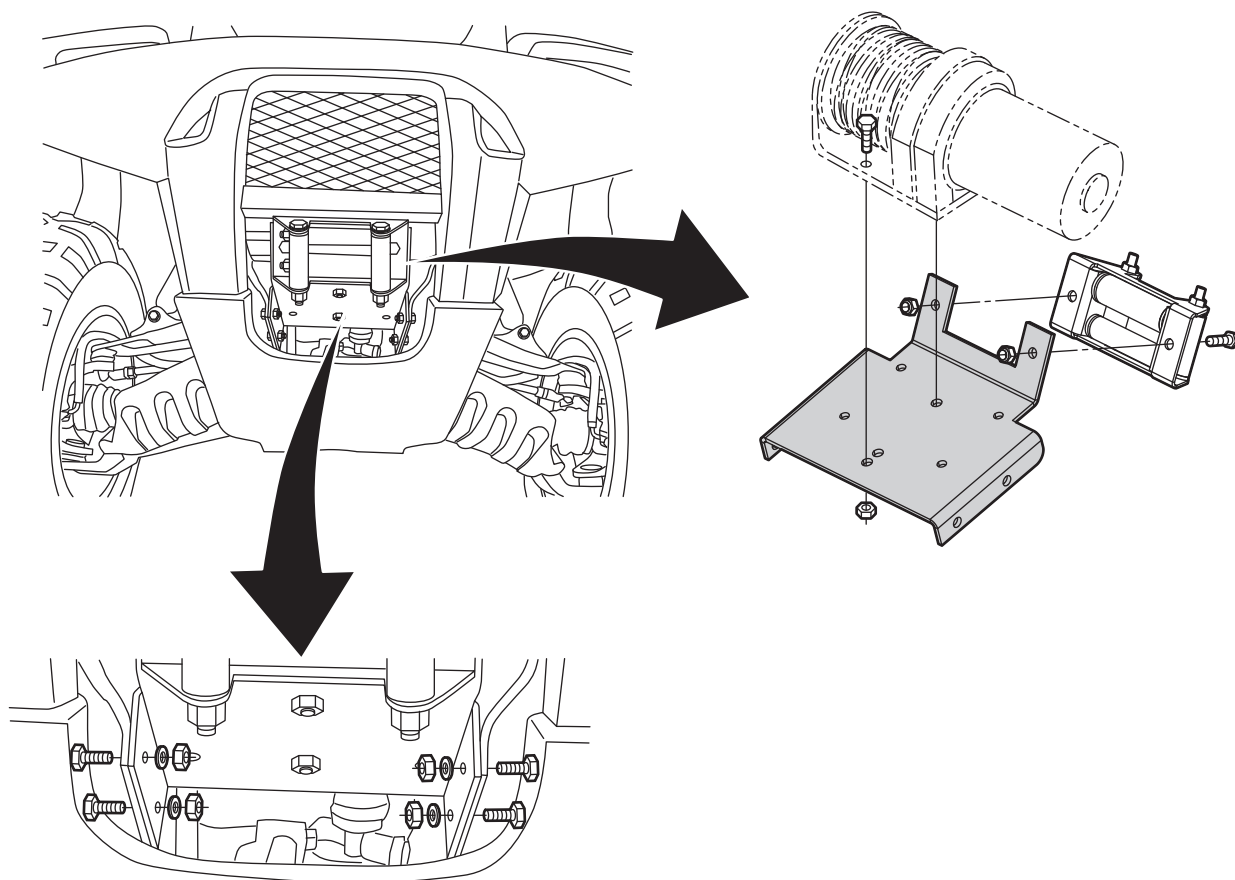

FOR QUESTIONS OR COMMENTS PLEASE CALL THE MANUFACTURER: **763-689-4800**

All images used are copyrighted property of CMP and may not be used without permission.

Inst1554M 10/31/06