



Winch Mount

Honda '07-08 Foreman S/ES/PS 500,
'07-08 Rubicon 500

Part Number: 1529M (4505-0366)

Item	Qty.	Part#	Description
1	1	1529-1	Winch Mounting Plate
2	2	1529-2	5/8" x 3/8" Spacers
3	2	HDW1054	8mm x 25mm Hex Head Bolts
4	2	HDW2056	5/16" x 2" Hex Head Bolts
5	2	HDW7058	5/16" Nylock Nuts
6	2	KD23P	1" U-Brackets
7	2	PC124	3/4" x 3/4" Spacers

1. Remove the upper and lower plastic OEM bumpers. Upper bumper requires the removal of the two push in screws on each side. Retain all of the hardware removed.
2. Remove the interior bumper stay bolts and discard. **Note: See illustration for location.**
3. Position the Winch Mounting Plate (1) as illustrated. Position a 5/8" x 3/8" Spacer (2) between the rear hole of the mounting plate and the frame. Insert a 8mm x 25mm Hex Head Bolts (3) and tighten. Repeat this step on the other side of the plate.
4. Place the U-Brackets (6) as illustrated onto the frame. Attach the front of the mounting plate using the 5/16" x 2" Hex Head Bolts (4), 3/4" x 3/4" Spacers (7), and two 5/16" Nylock Nuts (5) as illustrated.
5. Install the Roller Fairlead to the mounting bracket using two 5/16" x 3/4" Hex Head Bolts and two 5/16" Nylock Nuts as illustrated.

NOTE: Roller fairlead not included with this kit!

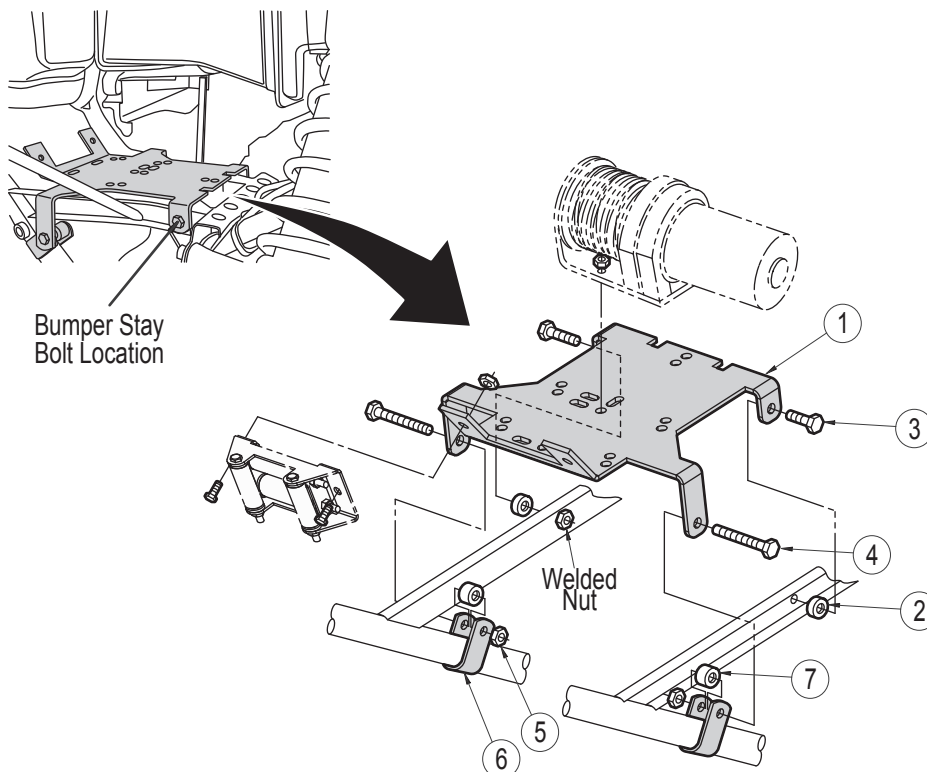

FOR QUESTIONS OR COMMENTS PLEASE CALL THE MANUFACTURER: **763-689-4800**

WARN WINCH

READ INSTRUCTION SHEET THOROUGHLY BEFORE BEGINNING

The purpose for this sheet is to explain the steps you must take to alter your Warn Winch to fit certain ATV models. This explains how to turn the power terminals from the vertical direction to the horizontal direction so it fits properly into the machine.



IMAGE #1



IMAGE #2



IMAGE #3

Image 1 shows how the Warn Winch will come when first purchased. As you can see, the power terminals are in the vertical direction and the two hex bolts are in the horizontal direction. Loosen the two hex bolts on the end of the motor. Carefully remove the motor and washer and set aside as illustrated in image 2. **DO NOT TAKE THE MOTOR CASING APART.** Remove the four allen head bolts as illustrated in image 3.



IMAGE #4



IMAGE #5



IMAGE #6

Remove the gear box as illustrated in image 4. Carefully remove the gears as illustrated in image 5 and set aside. Remove the two plastic washers as illustrated in image 6.



IMAGE #7



IMAGE #8



IMAGE #9

Inside the gear casing you will see two floating nuts. Remove the two floating nuts and place them into the opposite slots of the gear casing as illustrated in image in image 7, 8 and 9.



IMAGE #10

Reassemble the winch the same way it was unassembled. The only difference is that the terminals on the motor will be in the horizontal direction and the hex bolts will be in the vertical direction as illustrated in image 10.

NOTE: Some older model Warn Winches will NOT be required to be completely unassembled. Some older models already contain a second set of floating nuts. All that is required in this case is to remove the motor, turn it 90 degrees and reattach. DO NOT TAKE THE MOTOR CASING APART.

IT IS RECOMMENDED THAT YOUR LOCAL MECHANIC OR DEALER PERFORM THIS TASK