



Qty.	Part #	Description
1	1522-1	Winch Mount
2	HDW2050	5/16" x 3/4" Hex Bolts
2	HDW7058	5/16" Nylock Nuts

NOTE: Roller fairlead not included with this kit!

Winch Mount Installation Instructions

for '99-'05 Bombardier Quest & Traxter
Part Number: 1522M (4505-0362)

INSTRUCTIONS:

1. Remove the front plastic bumper wrap.
2. Remove the (4) bolts that hold the OEM winch mount.
3. Install the winch mount per the illustration, using the original nuts and bolts.
4. Install the winch to the mount upside down using the hardware provided with the winch.
6. **Optional:** Place the plastic bumper wrap against the bumper and mark the opening for the roller fairlead. Cut the plastic bumper wrap where marked. Replace the wrap using the bolts you removed.
7. Install the roller fairlead to the front of the mount using (2) 5/16" x 3/4" bolts and 5/16" Nylock nuts provided (rollers should turn freely). **Note:** Bottom roller may need to be removed to run wire rope through.
8. Using the instructions provided with the winch, wire accordingly.

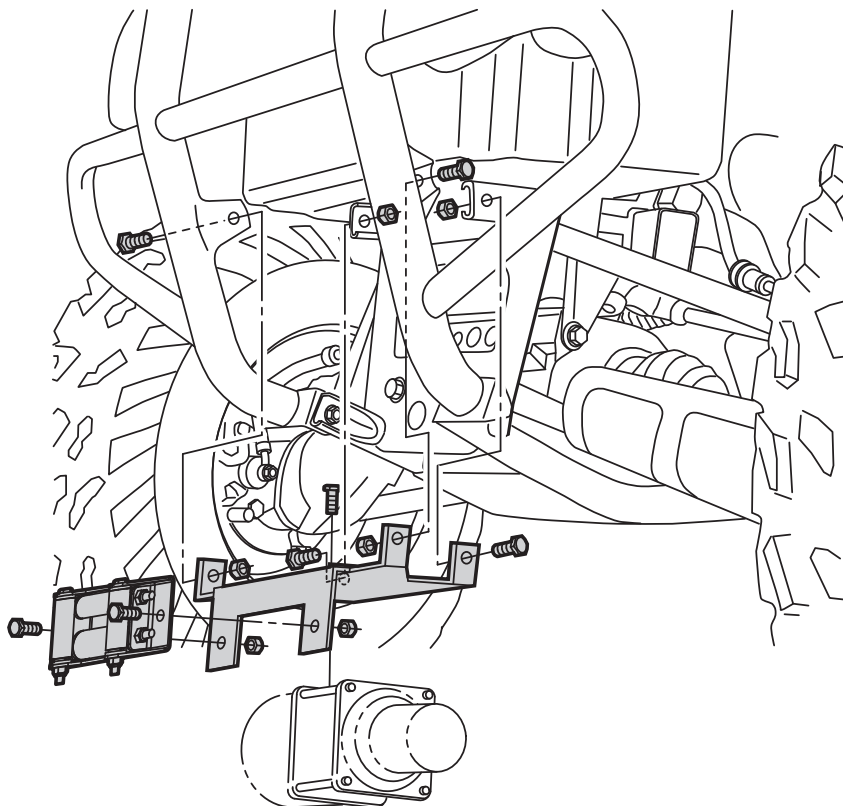

FOR QUESTIONS OR COMMENTS PLEASE CALL THE MANUFACTURER: **763-689-4800**