

Rear Bumper Mounting Instructions

2007-09 Yamaha Grizzly 550/700

Part Number: 3415 (0530-1154)

Ref.	Qty.	Part#	Description
1	1	3415-1	Rear Bumper
2	2	HDW1051	8mm x 20mm Hex Bolts
3	2	PC123	Spacers
4	2	HDW2004	1/4" x 1 3/4" Hex Bolts
5	2	HDW7050	1/4" Nylock Nuts
6	2	KD20P	U-Clamps
7	4	HDW9064	1 5/8" Endcaps

INSTRUCTIONS:

1. Remove the stock bolts holding the back of the rear rack to the rear rack supports. The rear bumper mounts will sandwich between the rack and the rack supports.
2. Start by sliding the brushguard into place with the upper mounting tabs between the rack and the rack supports. Loosely install an 8mm x 20mm hex bolt on each side.
3. Place a u-clamp facing inward over the rack support aligned with the lower bumper mount. Loosely bolt in place using a 1/4" x 1 3/4" hex bolt, spacer (inside the u-clamp), and 1/4" nylock nut. Repeat for the other side. See Illustration.
3. Make sure the bumper is aligned properly with the rear of the machine and tighten all nuts and bolts.
4. Using a rubber mallet, lightly tap the endcaps into place on the brushguard.

NOTE: This bumper is designed to be used as a brushguard only and should not be used to push heavy objects. Bent or damaged bumpers will not be warranted.

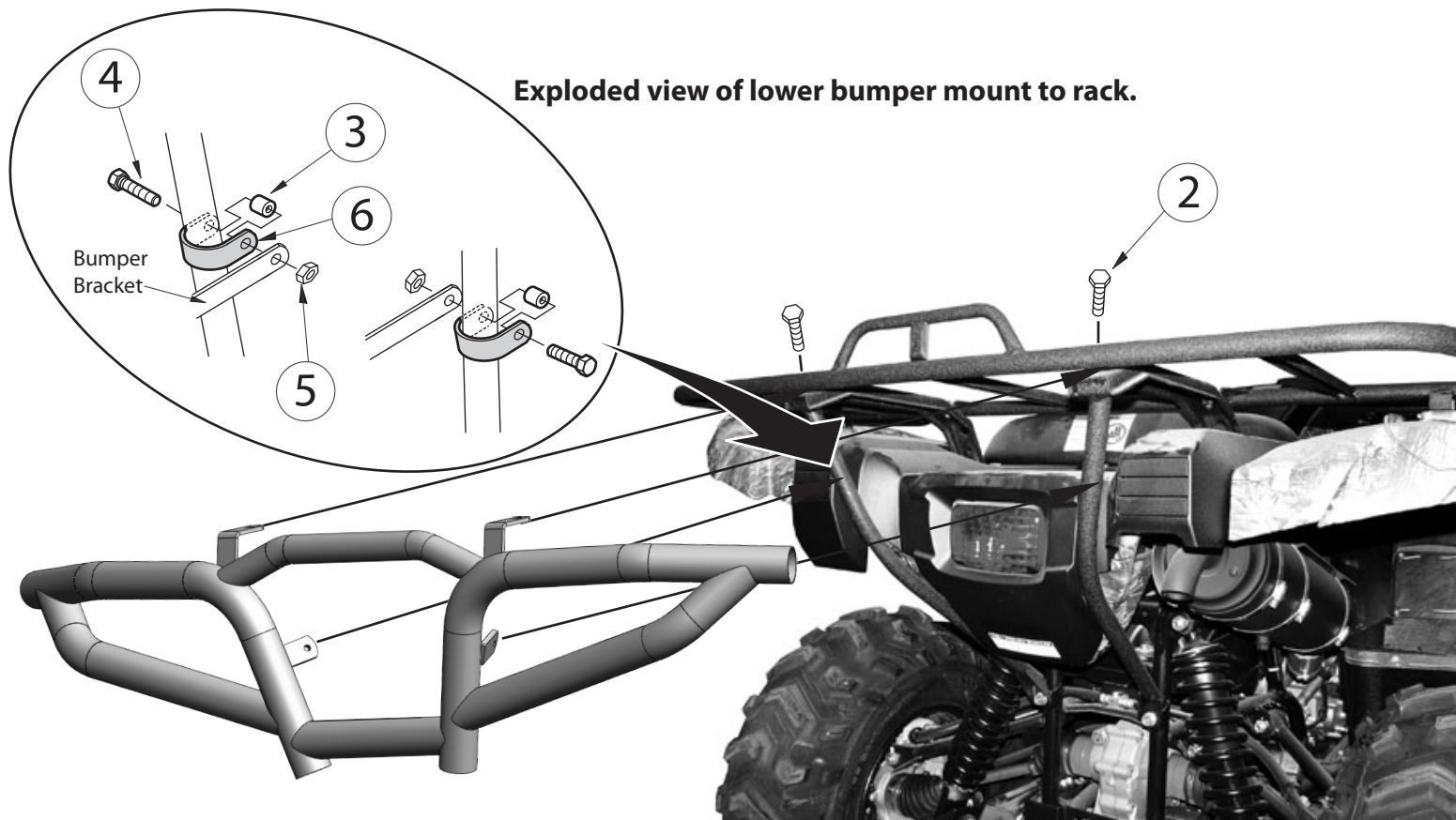

FOR QUESTIONS OR COMMENTS PLEASE CALL: 763-689-4800